

CERTIFICATE OF LOCATION OF GOVERNMENT CORNER

EAST QUARTER Corner of Section 32, Township 42, Range 24, 4TH P.M.
 STATE OF MINNESOTA, County of KANABEC

At the corner location shown on the sketch:
 SET #7 REBAR WITH ALUMINUM CAP

Kanabec County U.S. Survey Feet Coordinates
 NAD 1983, HARN 1996 Adjustment
 Obtained by RTK GPS Observation

Northing= 227082.92
 Easting= 375660.31

Note: NAD 1983, HARN 1996 Adjustment
 coordinates are NOT compatible with
 NAD 1983 coordinates
 Note: 1 Meter=3937/1200 U.S. Survey Feet

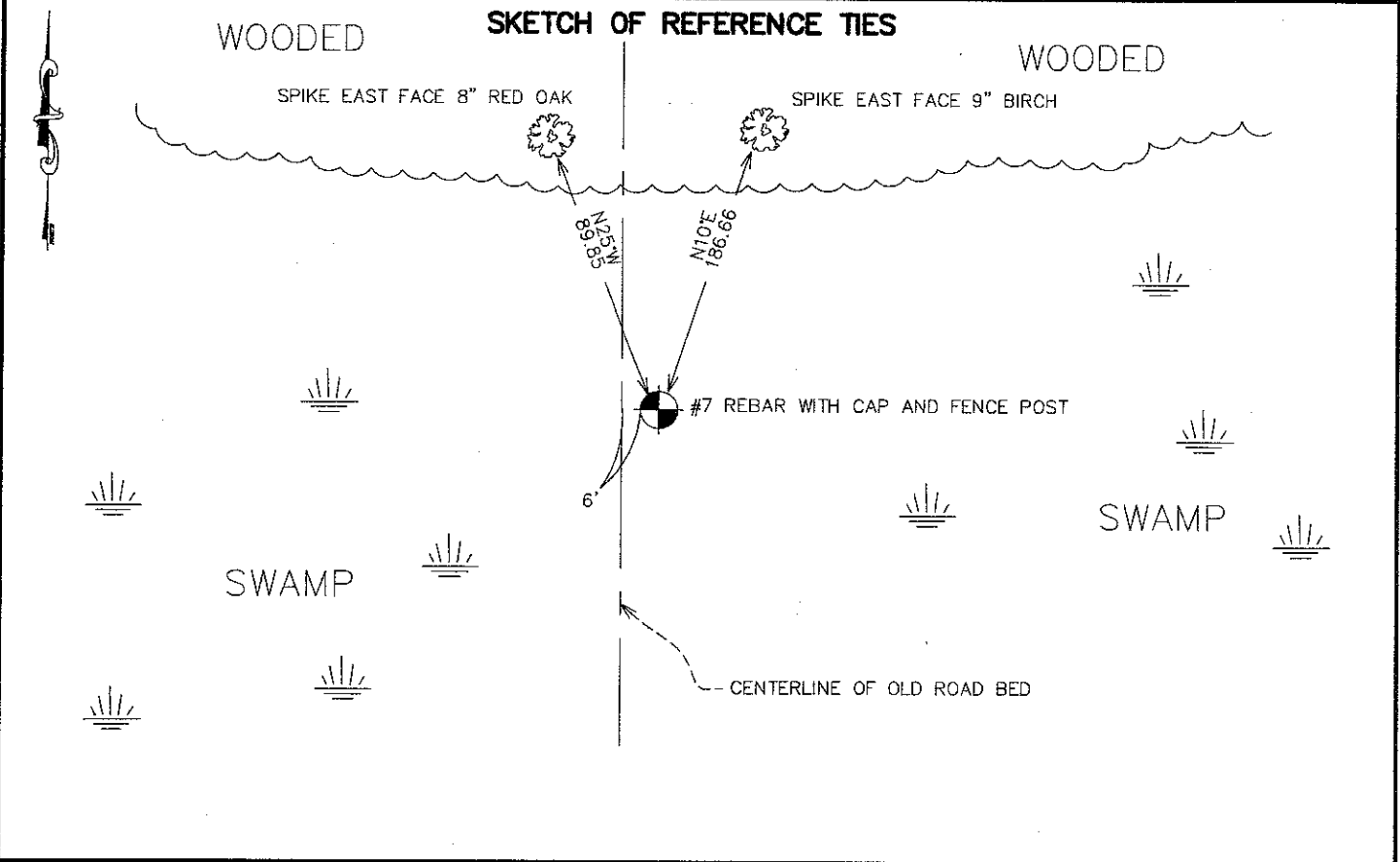

Statement of evidence relative to this corner location is on back of page.

I hereby certify that this document and the data contained herein was prepared by me or under my direct supervision.

Signature _____ Date _____

Registration No. _____

- Land Surveyor, Professional Engineer
- County Surveyor, County Engineer

OFFICE OF THE COUNTY RECORDER

County of _____

I hereby certify that this document was filed in the County Recorder's office at _____ M. on the _____ day of _____ A.D., 20____

County Recorder _____

BY _____ Deputy

DOCUMENT NO. _____

EAST QUARTER CORNER SECTION 32, T42, R24

STATEMENT OF EVIDENCE

THE ORIGINAL CORNER POST WAS SET BY DEPUTY SURVEYOR ISAAC BANKER ON DECEMBER 13, 1855 AND 2 BALSAM SPRUCE WERE USED AS BEARING TREES - NO VISIBLE EVIDENCE REMAINS FOR THE CORNER OR BEARING TREE.

NO SUBSEQUENT SURVEYS COULD BE FOUND THAT USED THIS CORNER AT THE KANABEC COUNTY OFFICES.

A ROAD OPENING ALONG THE EAST LINE OF SECTION 32 WAS RECORDED ON JULY 10, 1914 IN COUNTY AUDITORS OFFICE.

IN OCTOBER 2006 E.G. RUD AND SONS RAN A SURVEY AROUND SECTIONS 19-21 AND 28-34. THIS CORNER FALLS ON THE CENTERLINE OF A NORTH SOUTH ROADBED WITH NO OCCUPATION LINES RUNNING EAST OR WEST.

A #7 REBAR WAS SET ON LINE AND AT SINGLE PROPORTIONATE MEASUREMENT BETWEEN THE NORTHEAST AND SOUTHEAST CORNER OF SECTION 32. TIES WERE TAKEN AND KANABEC COUNTY COORDINATES WERE ESTABLISHED ON THIS POSITION.