

CERTIFICATE OF LOCATION OF GOVERNMENT CORNER

NORTH QUARTER Corner of Section 34, Township 42, Range 24, 4TH P.M.
 STATE OF MINNESOTA, County of KANABEC

At the corner location shown on the sketch:
 ESTABLISHED KANABEC COUNTY COORDINATES ON THIS POSITION

Kanabec County U.S. Survey Feet Coordinates
 NAD 1983, HARN 1996 Adjustment
 Obtained by RTK GPS Observation

Northing= 230137.68
 Easting= 383691.68

Note: NAD 1983, HARN 1996 Adjustment
 coordinates are NOT compatible with
 NAD 1983 coordinates
 Note: 1 Meter=3937/1200 U.S. Survey Feet

SKETCH OF REFERENCE TIES

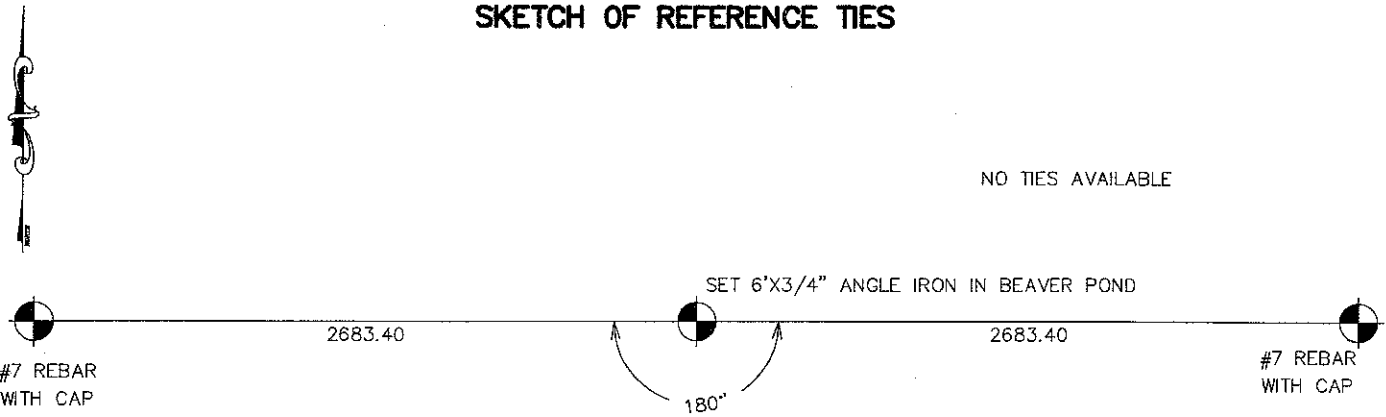

NO TIES AVAILABLE

Statement of evidence relative to this corner location is on back of page.

I hereby certify that this document and the data contained herein was prepared by me or under my direct supervision.

Ernest J. Reed 12-10-2007
 Signature Date

Registration No. Miss No 9808

Land Surveyor, Professional Engineer
 County Surveyor, County Engineer

OFFICE OF THE COUNTY RECORDER

County of _____

I hereby certify that this document was filed in the County Recorder's office at _____ M. on the _____ day of _____ A.D., 20____

County Recorder _____

BY _____ Deputy

DOCUMENT NO. _____

NORTH QUARTER CORNER SECTION 34, T42, R24

STATEMENT OF EVIDENCE

THE ORIGINAL CORNER POST WAS SET BY DEPUTY SURVEYOR ISAAC BANKER ON DECEMBER 11, 1855. A BIRCH AND SPRUCE TREE WERE USED AS BEARING TREES.

NO EVIDENCE FOR THE CORNER OR BEARING TREES REMAIN TODAY.

NO RECORDS OF ANY SUBSEQUENT SURVEYS COULD BE FOUND AT KANABEC COUNTY OFFICES.

IN OCTOBER 2006 E.G. RUD AND SONS DID A SURVEY AROUND SECTIONS 27 THRU 34 AND SET THIS CORNER ON LINE AND AT PROPORTIONATE MEASUREMENT BETWEEN THE NORTHEAST AND NORTHWEST CORNER OF SECTION 34. THIS CORNER FELL IN A BEAVER POND SO NO USABLE TIES COULD BE MADE TO THE CORNER. KANABEC COUNTY COORDINATES WERE ESTABLISHED ON THE CORNER.