

CERTIFICATE OF LOCATION OF GOVERNMENT CORNER

EAST QUARTER Corner of Section 27, Township 42, Range 24, 4TH P.M.

STATE OF MINNESOTA, County of KANABEC

At the corner location shown on the sketch:

FOUND THIS MOUMENT AND ESTABLISHED G.P.S. COORDINATES ON ITS LOCATION.

Kanabec County U.S. Survey Feet Coordinates
NAD 1983, HARN 1996 Adjustment
Obtained by RTK GPS Observation

Northing= 232914.7706

Easting= 386538.5874

Note: NAD 1983, HARN 1996 Adjustment coordinates are NOT compatible with NAD 1983 coordinates

Note: 1 Meter=3937/1200 U.S. Survey Feet

SKETCH OF REFERENCE TIES

TIES ARE TO SPIKE IN
BLAZE IN NEAR FACE

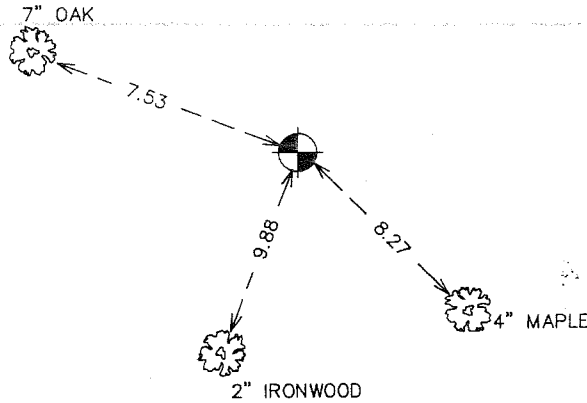

C/L TRAIL

Statement of evidence relative to this corner location is on back of page.

I hereby certify that this document and the data contained herein was prepared by me or under my direct supervision.

Ernest Blued
Signature

2-22-2007
Date

Registration No. Minn No 9808

Land Surveyor, Professional Engineer

County Surveyor, County Engineer

OFFICE OF THE COUNTY RECORDER

County of _____

I hereby certify that this document was filed in the County Recorder's office at _____ M. on the _____ day of _____ A.D., 20____

County Recorder _____

BY _____ Deputy

DOCUMENT NO. _____

EAST QUARTER CORNER SECTION 27, T42, R24

STATEMENT OF EVIDENCE

ALL OF THE ORIGINAL BEARING TREES ARE NOW GONE.

THERE IS NO RESURVEY DATA ON FILE FOR THIS CORNER.

IN APRIL OF 1988, M.B. RUDE RAN A SURVEY ALONG THE EAST LINE OF SECTION 27 TO SEARCH FOR EVIDENCE OF THIS CORNER.

THERE IS AN EXISTING TRAIL ALONG THE EAST LINE OF THE NORTHEAST QUARTER OF SECTION 27 BUILT BY GLEN REESE OF WARMAN, MINNESOTA, WHO SAID THAT THE ROAD WAS ALL BUILT IN SECTION 27 PER A SURVEY BY JOHN HANSON. JOHN HANSON IS A REGISTERED LAND SURVEYOR WITH THE DEPARTMENT OF TRANSPORTATION AT BRAINERD, MINNESOTA.

ON MAY 12, 1988, M.B. RUDE TALKED WITH JOHN HANSON AND HE SAID THAT ABOUT TEN YEARS AGO HE ONLY RAN A RANDOM LINE SOUTH BY EXTENDING THE ROAD TO THE NORTH OF THE NORTHEAST CORNER OF SECTION 27 AND FOUND OR SET NO CORNERS.

M.B. RUDE SET THIS CORNER BY SINGLE PROPORTIONAL MEASUREMENT BETWEEN THE NORTHEAST AND SOUTHEAST CORNERS OF SECTION 27. THIS LOCATION IS ABOUT 130 FEET WEST OF THE EXISTING NORTH-SOUTH TRAIL.

IN DECEMBER 2006 E.G. RUD AND SONS FOUND THIS MONUMENT AND ESTABLISHED KANABEC COUNTY COORDINATES USING G.P.S. EQUIPMENT