

# CERTIFICATE OF LOCATION OF GOVERNMENT CORNER

North Quarter Corner of Section 36, Township 42 North, Range 24 West,  
4th Principal Meridian, Kanabec County, State of Minnesota

At the corner location shown on the sketch:  
  
On 3/22/2013 set a 7/8" x 36" rebar monument with aluminum cap.

Kanabec County U.S. Survey Feet Coordinates  
NAD 1983, HARN 1996 Adjustment  
Obtained by RTK GPS observation  
Northing: 230324.0897  
Easting: 394359.0240  
  
Note: NAD 1983, HARN 1996 Adjustment  
coordinates are NOT compatible with  
NAD 1983 coordinates  
Note: 1 Meter = 3937/1200 U.S. Survey Feet

## SKETCH OF REFERENCE TIES

NOT TO SCALE

KROSCHEL LAND SURVEYORS, INC.  
ASSUMES NO LIABILITY FOR THE ACCURACY  
OF THE GPS COORDINATES SHOWN HEREON.  
ALL COORDINATES AND DIMENSIONS  
SHOULD BE FIELD VERIFIED BY THE USER.

THE BASIS OF BEARINGS FOR THIS  
DRAWING IS THE KANABEC COUNTY  
COORDINATE SYSTEM BY MNDOT,  
NAD 1983, HARN 1996 ADJUSTMENT

SECTION 25

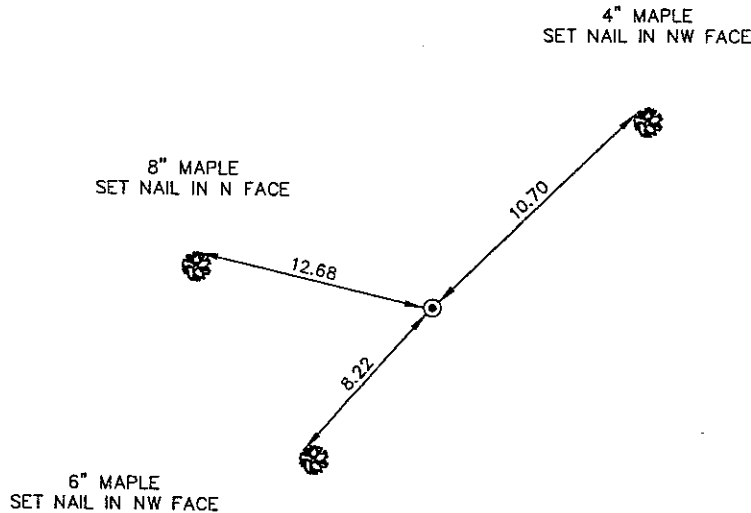

**Kroschel Land Surveyors, Inc.**

1639 Main Street North, Suite 6, Pine City, MN 55063  
Phone: 320-629-3267 Fax: 320-629-0176

Statement of evidence relative to this corner location is on back of page.

I hereby certify that this survey, plan, or report was prepared by me or under my direct supervision, that the United States public land survey monument record is correct and complete to the best of my knowledge and belief, and that I am a duly Licensed Land Surveyor under the laws of the State of Minnesota

Tyler J. Kroschel

4-4-2013  
Date

License No. 44490

Land Surveyor

County Surveyor

### OFFICE OF THE COUNTY RECORDER

County of Kanabec

I hereby certify that this document was filed in the County Recorder's office at \_\_\_\_\_ .M. on the \_\_\_\_\_ day of \_\_\_\_\_ A.D., 20\_\_\_\_

County Recorder \_\_\_\_\_

By \_\_\_\_\_, Deputy

DOCUMENT NO. \_\_\_\_\_

120/38

Statement of Evidence:

In November of 1855, Deputy Surveyor Isaac Banker set a post to mark the North Quarter Corner of Section 36, Township 42 North, Range 24 West, 4th Principal Meridian.

Reference ties were taken to:

- 40 inch White Pine at South 70 degrees West a distance of 41 links
- 36 inch White Pine at North 52 degrees West a distance of 60 links

All of the original Government corner evidence was searched for. None was found.

In March 2013, a survey was made around Section 25, Township 42 North, Range 24 West, 4th Principal Meridian for Shawn Caron to locate existing monuments, lines of occupation and establish search areas.

On 3/22/2013 a search was made by probing with machetes and checking with a magnetic locator. No evidence of corner was found.

I established this corner on line and halfway between the Northwest corner and the Northeast corner of Section 36.

On 3/22/2013, I set a 7/8" x 36" rebar monument with aluminum cap, established reference ties and assigned Kanabec County Coordinates. This location was determined to be the best available evidence of the original government corner location.



**Kroschel Land Surveyors, Inc.**

1639 Main Street North, Suite 6, Pine City, MN 55063  
Phone: 320-629-3267 Fax: 320-629-0176