

CERTIFICATE OF LOCATION OF GOVERNMENT CORNER

NORTHEAST Corner of Section 35, Township 42, Range 24, 4TH P.M.
 STATE OF MINNESOTA, County of KANABEC

At the corner location shown on the sketch:
 FOUND THIS MOUMENT
 AND ESTABLISHED G.P.S. COORDINATES ON ITS LOCATION.

Kanabec County U.S. Survey Feet Coordinates
 NAD 1983, HARN 1996 Adjustment
 Obtained by RTK GPS Observation
 Northing= 230368.0340
 Easting= 391726.5012
 Note: NAD 1983, HARN 1996 Adjustment
 coordinates are NOT compatible with
 NAD 1983 coordinates
 Note: 1 Meter=3937/1200 U.S. Survey Feet

SKETCH OF REFERENCE TIES

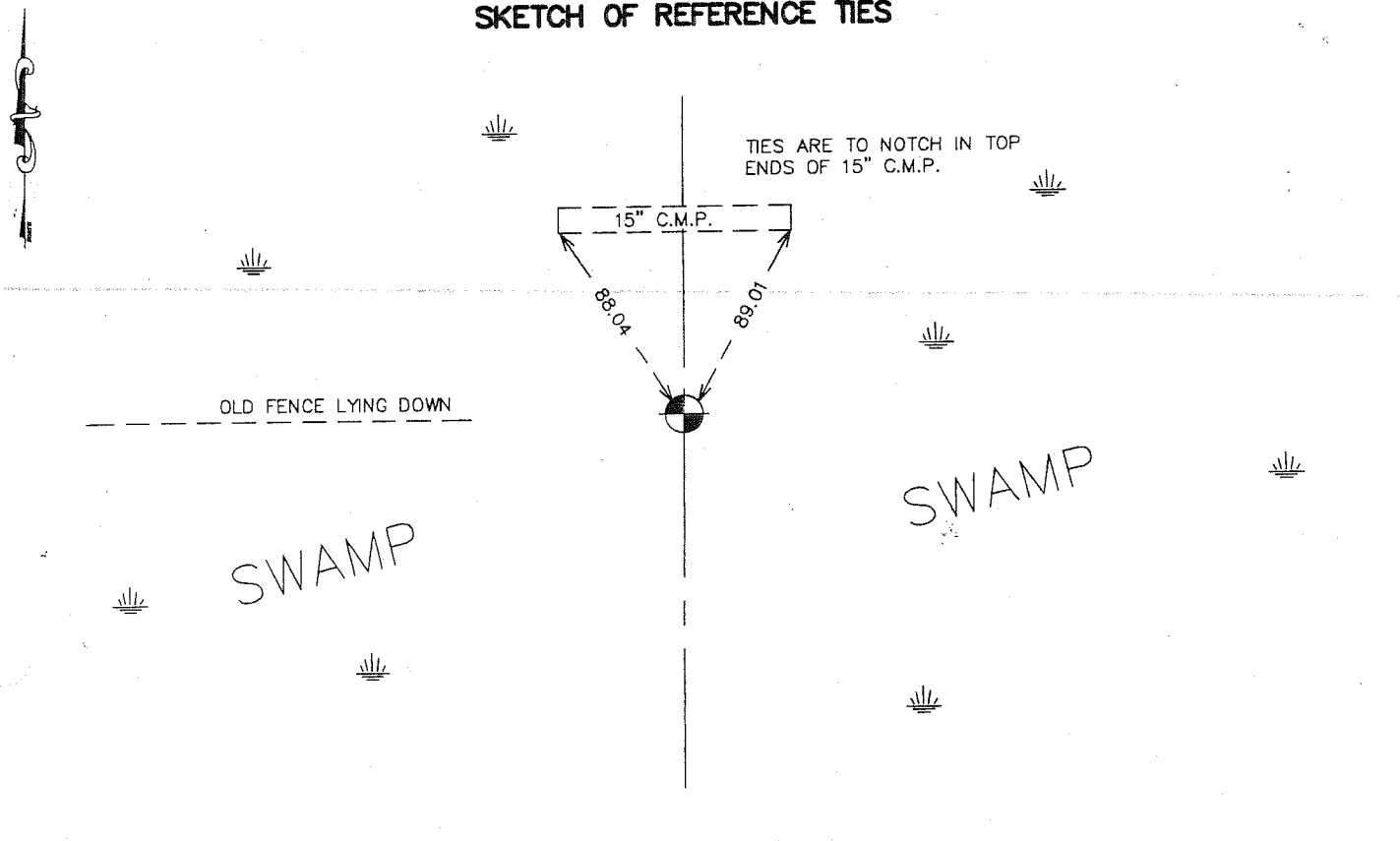

Statement of evidence relative to this corner location is on back of page.

I hereby certify that this document and the data contained herein was prepared by me or under my direct supervision.

Ernest Blud 2-22-2007
 Signature Date

Registration No. Minn No 9808
 Land Surveyor, Professional Engineer
 County Surveyor, County Engineer

OFFICE OF THE COUNTY RECORDER

County of _____
 I hereby certify that this document was filed in the County Recorder's office at _____ M. on the _____ day of _____ A.D., 20____
 County Recorder _____
 BY _____ Deputy
 DOCUMENT NO. _____

NORTHEAST CORNER SECTION 35, T42, R24

STATEMENT OF EVIDENCE

ALL OF THE ORIGINAL BEARING TREES ARE NOW GONE.

THERE IS A TOWN ROAD ORDER ON FILE DATED JANUARY 9, 1901, AND SURVEYED BY JOHN NELSON, STARTING AT THE EAST QUARTER CORNER OF SECTION 26 AND RUNNING SOUTH TO THE TOWN LINE A DISTANCE OF 8184 FEET.

THERE IS A NORTH-SOUTH ROAD AND AN OLD FENCE LINE WEST AT THIS LOCATION IN A SWAMP. NO EXCAVATION WAS MADE AS THE ROAD HAD BEEN CORDUROYED AND ALL EVIDENCE WAS DESTROYED.

IN APRIL OF 1988, M.B. RUDE RAN A SURVEY AROUND SECTIONS 23, 26, AND 35, TOWNSHIP 42 RANGE 24, TO LOCATE EXISTING MONUMENTS, LINES OF OCCUPATION AND SEARCH AREAS.

THE LOCATION OF THE CENTERLINE OF THE ROAD AND OLD FENCE LINE WEST EXTENDED EAST AND IS IN HARMONY WITH NELSON'S SURVEY FROM 1901 AND WAS ACCEPTED AS THE PERPETUATED LOCATION OF THE ORIGINAL CORNER LOCATION.

IN NOVEMBER 2006 E.G. RUD AND SONS FOUND AN ALUMINUM CAPPED REBAR AT THIS POSITION AND ESTABLISHED KANABEC COUNTY COORDINATES ON THE MONUMENT USING G.P.S. EQUIPMENT.