

ok.

# CERTIFICATE OF LOCATION OF GOVERNMENT CORNER

KANABEC COUNTY

No. 750

I hereby certify that on the 29th day of June, 1981, that I John O. Oliver  
 did find the North West SW corner of Section 6 31, Township 41 42, Range 24  
 said County, which was ~~reestablished by~~ Evidenced by a 3/4 inch iron pin flush at PI 1280 + 29.7 which is in place of a  
 6"x6" concrete post per D.O.T.'s Highway 47 right-of-way map

I further certify that to perpetuate the location of said corner I did at the exact location thereof place  
 a permanent marker consisting of left 3/4 inch iron pin as is

I further certify that I did establish 5 references or witness monuments as shown below. Said references  
 being marked as shown by the following abbreviations: (BP = Tree with | facing painted blaze with | nail.  
 N = Tree, pole, etc. not blazed but with | nail in face. CF = Corner of foundation of building. CS = Corner of siding of building.)

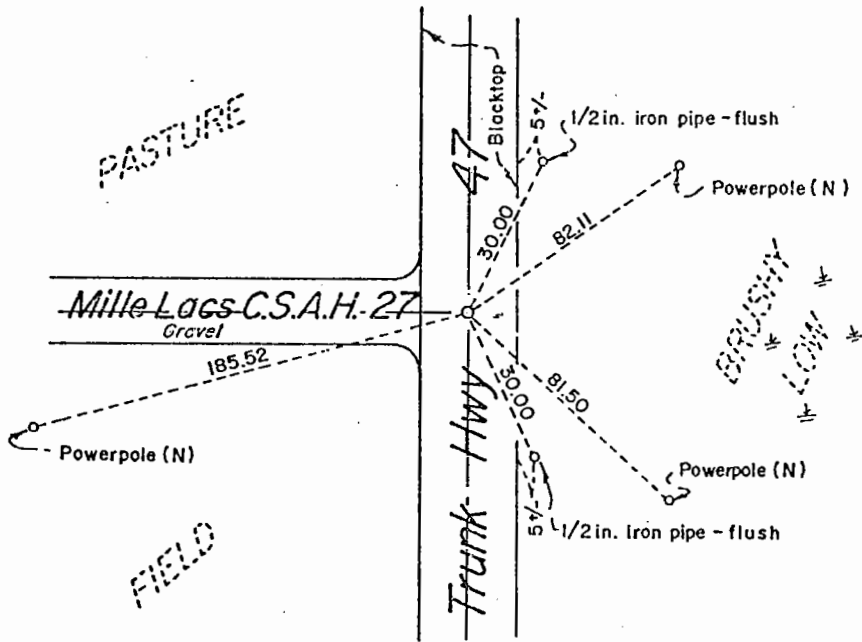

Dated this 4th day of January, 19 82.

John O. Oliver

Registered Land Surveyor No. 8194

Mille Lacs County Surveyor

Deputy Co. Surveyor

Office of the Register of Deeds for said County:

I hereby certify that the within instrument was  
 filed for record on the \_\_\_\_\_ day of \_\_\_\_\_  
 19\_\_\_\_.

Register of Deeds

By \_\_\_\_\_ Deputy.

36	31
1	6