

# CERTIFICATE OF LOCATION OF GOVERNMENT CORNER

North Quarter corner of Section 32, Township 42 North, Range 23 West,  
4th Principal Meridian, Kanabec County, State of Minnesota

At the corner location shown on the sketch:  
On 1/10/2019 found a 1/2" iron pipe marked RLS 9808.

Kanabec County U.S. Survey Feet Coordinates  
NAD 1983, HARN 1996 Adjustment  
Obtained by RTK GPS observation  
Northing: 230262.5481  
Easting: 405087.3650

Note: NAD 1983, HARN 1996 Adjustment  
coordinates are NOT compatible with  
NAD 1983 coordinates

Note: 1 Meter = 3937/1200 U.S. Survey Feet

## SKETCH OF REFERENCE TIES

NOT TO SCALE

DISTANCE UNITS FOR THIS DRAWING IS  
U.S. SURVEY FEET

THE BASIS OF BEARINGS FOR THIS  
DRAWING IS THE KANABEC COUNTY  
COORDINATE SYSTEM BY MNDOT,  
NAD 1983, HARN 1996 ADJUSTMENT



### SECTION 29

NW CORNER OF  
SECTION 32, T.42, R.23  
RUD COORDINATE

N 1/4 CORNER OF  
SECTION 32, T.42, R.23  
FOUND IP 9808

NE CORNER OF  
SECTION 32, T.42, R.23  
FOUND ALUM CAP

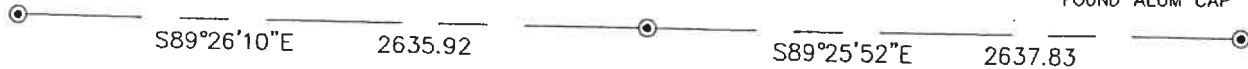

### SECTION 32



**Kroschel Land Surveyors, Inc.**

1639 Main Street North, Suite 6, Pine City, MN 55063  
Phone: 320-629-3267 Fax: 320-629-0176

Statement of evidence relative to this corner location is on back of page.

I hereby certify that this report was prepared by me  
or under my direct supervision, that the United  
States public land survey monument record is  
correct and complete to the best of my knowledge  
and belief, and that I am a duly Licensed Land  
Surveyor under the laws of the State of Minnesota.

Tyler J. Kroschel, County Surveyor

3-1-2022  
Date

License No. 44490

**OFFICE OF THE COUNTY RECORDER**  
County of Kanabec

I hereby certify that this document was filed in the  
County Recorder's office at \_\_\_\_\_ .M. on the  
\_\_\_\_\_ day of \_\_\_\_\_ A.D., 20\_\_\_\_

County Recorder \_\_\_\_\_  
\_\_\_\_\_, Deputy

DOCUMENT NO. \_\_\_\_\_

Statement of Evidence:

In October of 1857, Deputy Surveyor John M. Gay set a post to mark the North Quarter Corner of Section 32, Township 42 North, Range 23 West, 4th Principal Meridian.

Reference ties were taken to:

- 7 inch Sugar at South 29 degrees East a distance of 11 links
- 7 inch Sugar at North 25 degrees East a distance of 14 links

All of the original Government corner evidence was searched for. None was found.

In January 2019, I made a survey around Section 32, Township 42 North, Range 23 West, 4th Principal Meridian to locate existing monuments, lines of occupation and establish search areas.

On 1/10/2019, I made a search with a metal locator. Near a lost location, I found a 1/2" Iron Pipe marked LS 9808. I accepted the found Iron Pipe as the best available evidence of the original monument location and assigned Kanabec County Coordinates.