

CERTIFICATE OF LOCATION OF GOVERNMENT CORNER

Southeast Corner of Section 5, Township 42, Range 23, 4th P.M.
STATE OF MINNESOTA, County of KANABEC

At the corner location shown on the sketch:

Found a Kanabec County Monument.

Kanabec County U.S. Survey Feet Coordinates
NAD 1983, HARN 1996 Adjustment
Obtained by RTK GPS Observation

Northing= 251421.70

Easting= 408049.03

Note: NAD 1983, HARN 1996 Adjustment coordinates are NOT compatible with NAD 1983 coordinates

Note: 1 Meter=3937/1200 U.S. Survey Feet

SKETCH OF REFERENCE TIES

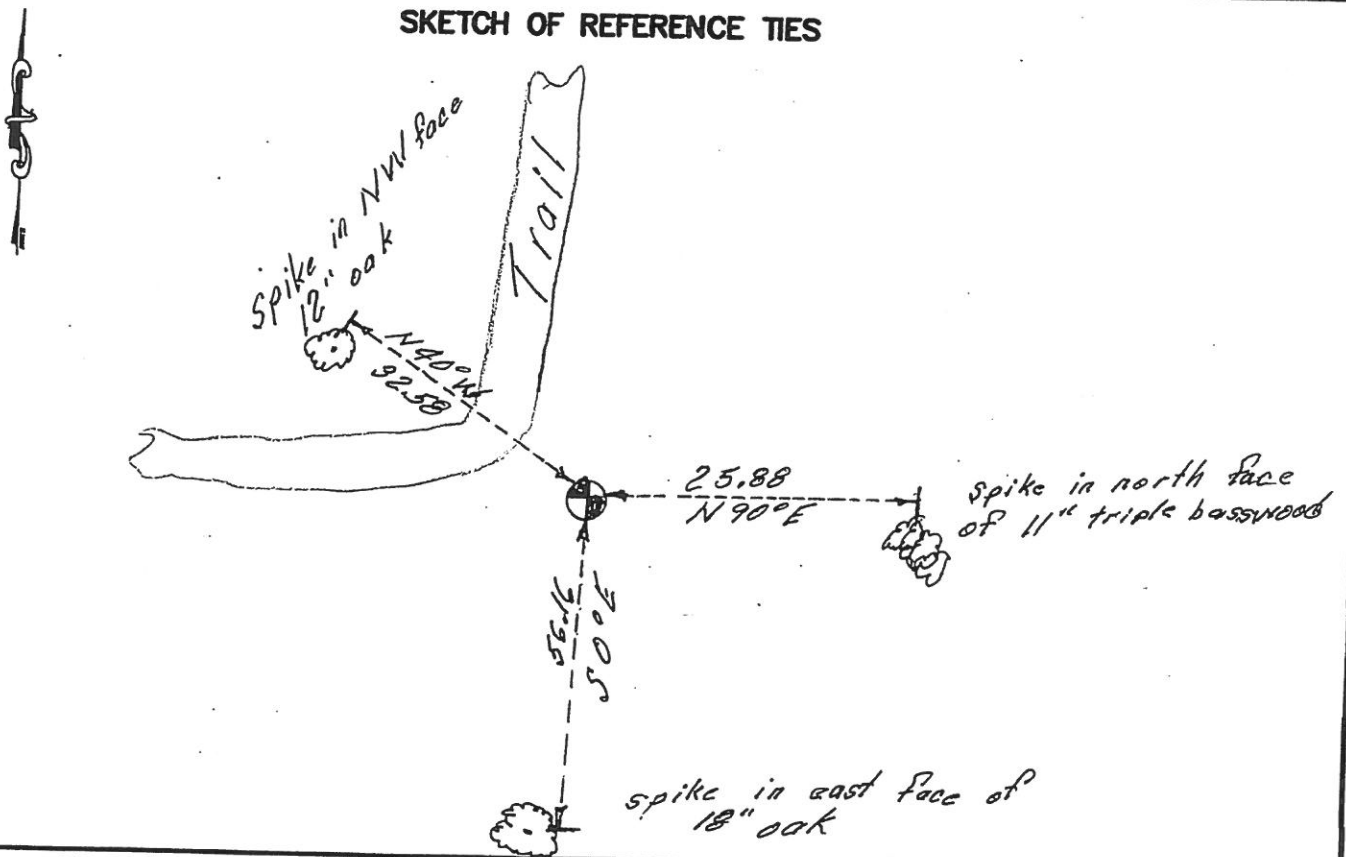

Statement of evidence relative to this corner location is on back of page.

I hereby certify that this document and the data contained herein was prepared by me or under my direct supervision.

[Signature]
Signature

1-04-2018
Date

Registration No. 41578

Land Surveyor, Professional Engineer

County Surveyor, County Engineer

OFFICE OF THE COUNTY RECORDER

County of _____

I hereby certify that this document was filed in the County Recorder's office at _____ M. on the

_____ day of _____ A.D., 20__

County Recorder _____

BY _____ Deputy

DOCUMENT NO. _____

Southeast corner Section 5, Township 42, Range 23

4223110

In January 2018, while doing a survey in the Northwest Quarter and Northeast Quarter of Section 5, E.G. Rud & Sons, Inc., located a Kanabec County monument at this location. It fit the mathematical information obtained by M.B. Rude in March 1974 when he set this corner within a 0.10 of a foot. We accepted this monument for the Southeast corner of Section 5, took new ties and established Kanabec County coordinates on this position.