

# CERTIFICATE OF LOCATION OF GOVERNMENT CORNER

NORTH QUARTER Corner of Section 33, Township 42, Range 23, 4TH P.M.  
 STATE OF MINNESOTA, County of KANABEC

At the corner location shown on the sketch:  
 SET A 24" X 7/8" REBAR WITH KANABEC COUNTY ALUMINUM DISK  
 6" BELOW GRADE ON CENTERLINE.

Kanabec County U.S. Survey Feet Coordinates  
 NAD 1983, HARN 1996 Adjustment  
 Obtained by RTK GPS Observation

Northing= 230207.318

Easting= 410369.737

Note: NAD 1983, HARN 1996 Adjustment  
 coordinates are NOT compatible with  
 NAD 1983 coordinates

Note: 1 Meter=3937/1200 U.S. Survey Feet

## SKETCH OF REFERENCE TIES

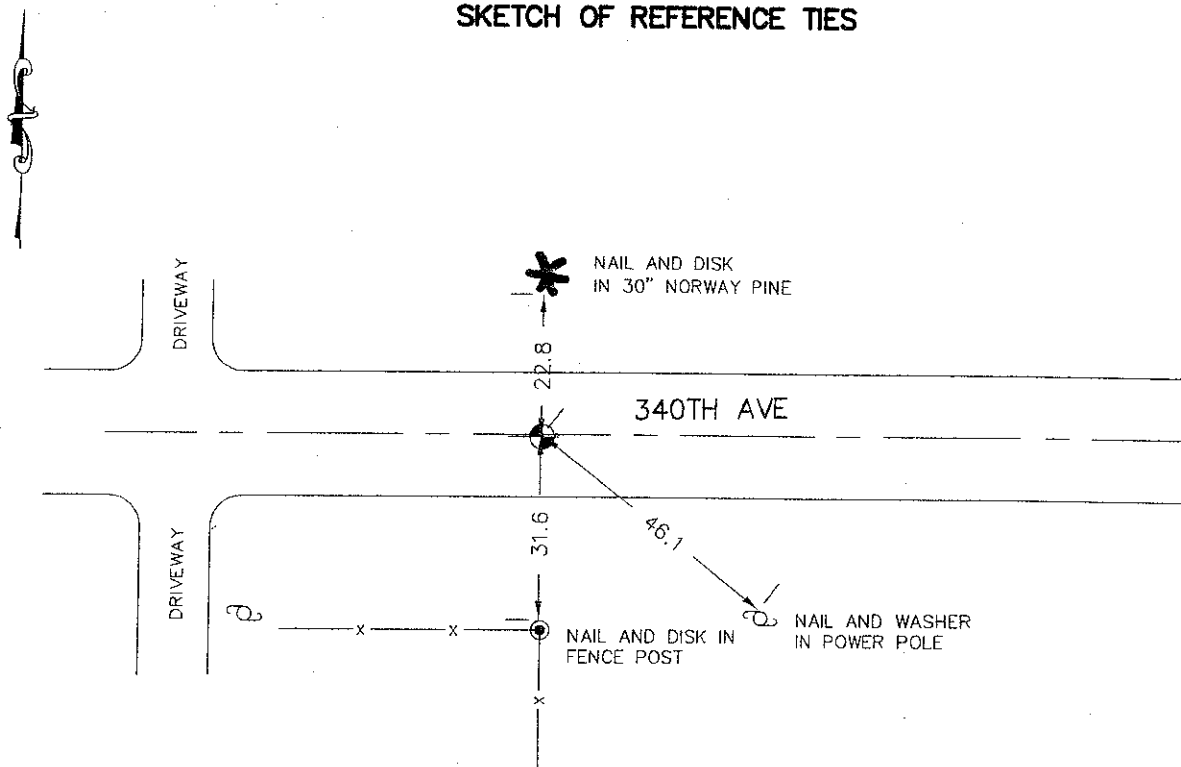

Statement of evidence relative to this corner location is on back of page.

I hereby certify that this document and the data contained herein was prepared by me or under my direct supervision.

*Ernest J. Reed*  
 Signature

3-17-2009  
 Date

Registration No. Minn No. 9808

Land Surveyor,      [ ] Professional Engineer

[ ] County Surveyor,      [ ] County Engineer

### OFFICE OF THE COUNTY RECORDER

County of \_\_\_\_\_

I hereby certify that this document was filed in the County Recorder's office at \_\_\_\_\_ M. on the

\_\_\_\_\_ day of \_\_\_\_\_ A.D., 20\_\_

County Recorder \_\_\_\_\_

BY \_\_\_\_\_ Deputy

DOCUMENT NO. \_\_\_\_\_

NORTH QUARTER CORNER SECTION 33, TOWNSHIP 42, RANGE 23

**STATEMENT OF EVIDENCE**

THE ORIGINAL CORNER WAS SET BY D.S. JOHN M. GIAY ON OCTOBER 21, 1851 AND 2 BALSAM TREES WERE USED AS BEARING TREES. NO VISIBLE EVIDENCE REMAINS FOR THE CORNER POST OR BEARING TREES TODAY.

THERE IS A ROAD OPENING ON FILE ALONG THE NORTH LINE OF SECTION 33 DATED JULY 26, 1913 AND VICKEREY NOTED A DISTANCE OF 80 CHAINS ALONG THIS LINE. IN MARCH 2003, E.G. RUD AND SONS MEASURED SEVERAL SECTION LINES TO PERFORM A SURVEY IN SECTION 23 TYING IN EXISTING MONUMENTS AND LINES OF OCCUPATION. THIS CORNER FALLS ON THE CENTER LINE OF AN EAST-WEST TOWNSHIP ROAD AND A WELL ESTABLISHED FENCE LINE TO THE SOUTH. \*THIS LOCATION WAS DETERMINED TO BE THE BEST EVIDENCE TO THE POSITION OF THIS CORNER. IN MARCH 2007 MOORE ENGINEERING INC. OF FERGUS FALLS SET A MONUMENT AND TOOK THIS AT THE POSITION PREVIOUSLY ESTABLISHED BY E.G. RUD AND SONS.

\*NO EXCAVATION WAS DONE AS THIS FELL IN A CUT SECTION OF THE ROAD SO ALL EVIDENCE WOULD HAVE BEEN DESTROYED.