

# CERTIFICATE OF LOCATION OF GOVERNMENT CORNER

E 1/4 Corner of Section 4, Township 42, Range 23, 4<sup>TH</sup> P.M.

STATE OF MINNESOTA, County of KANABEC

At the corner location shown on the sketch

On \_\_\_\_\_ found a \_\_\_\_\_  
Date

left monument as found,  lowered monument,  removed monument (explain)

On 2-13-95 placed a 7/8" x 6' CAPPED REBAR  
Date

### SKETCH OF REFERENCE TIES

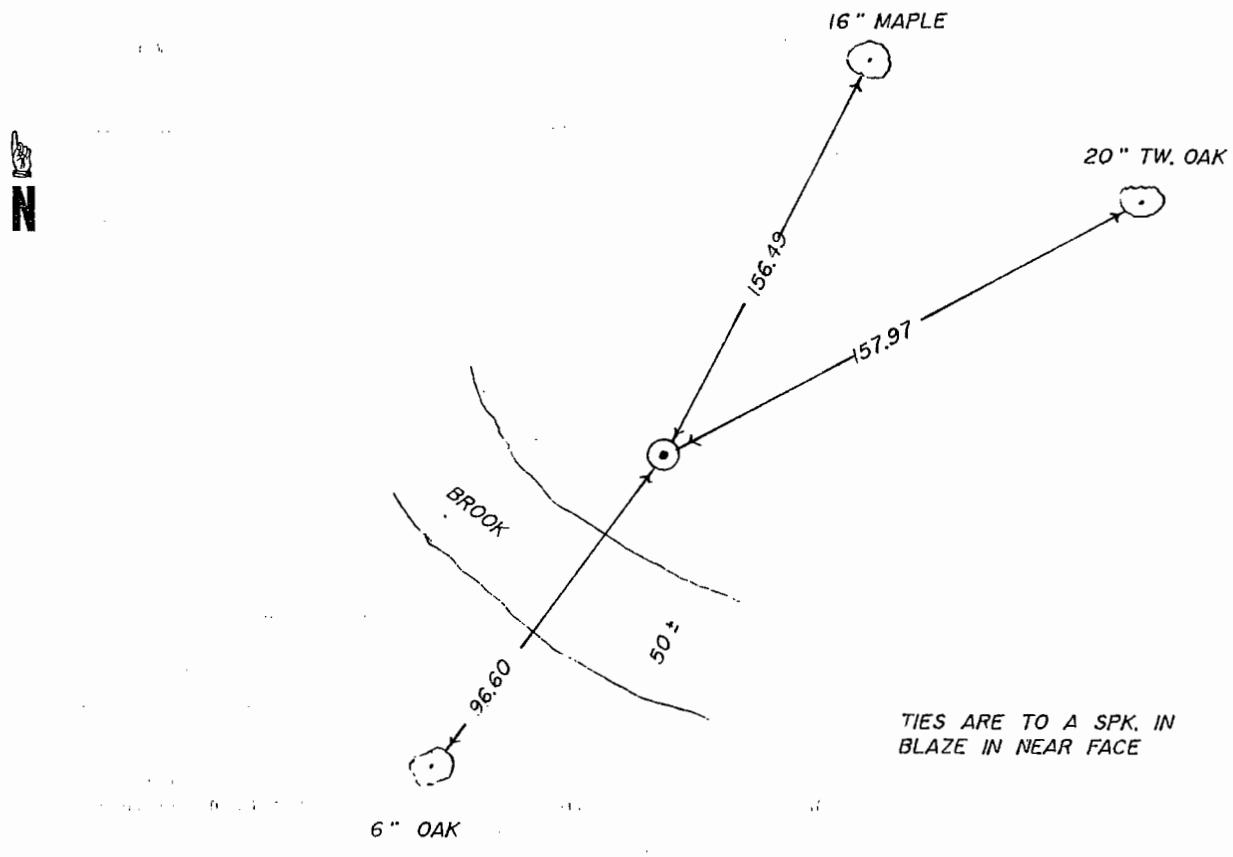

Statement of evidence relative to this corner location is on back of page.

I hereby certify that this document and the data contained herein was prepared by me or under my direct supervision.

*M. B. [Signature]* 7-7-95  
Signature Date

Registration No. 8195

Land Surveyor,  Professional Engineer  
 County Surveyor,  County Engineer

### OFFICE OF THE REGISTER OF DEEDS

County of \_\_\_\_\_

I hereby certify that this document was filed in the Register of Deeds office at \_\_\_\_\_ M. on the

\_\_\_\_\_ day of \_\_\_\_\_ A.D., 19\_\_\_\_\_

Register of Deeds \_\_\_\_\_

By \_\_\_\_\_, Deputy

DOCUMENT NO. \_\_\_\_\_

## STATEMENT OF EVIDENCE

All of the original government bearing trees are now gone.

There is no resurvey data on file for this corner.

In February of 1974, we made a survey in Sections 3, 4, 5 and 6 of Township 42, Range 23.

In February of 1995, we made a survey around the east half of Section 5, Township 42, Range 23, and the west half of Section 4, Township 42, Range 23, to locate existing monuments, lines of occupation and to establish search areas.

We made a search with a magnetic locator. No evidence was found of this corner in the search.

We set the east quarter corner of Section 4, Township 42, Range 23, on line and a proportional distance between the computed locations of the northeast and southeast corners of Section 4, Township 42, Range 23, from our 1974 survey data.