

CERTIFICATE OF LOCATION OF GOVERNMENT CORNER

W. 1/4 Corner of Section 23, Township 42, Range 23, 4th P.M.

STATE OF MINNESOTA, County of KANABEC

At the corner location shown on the sketch:

- On _____ found a _____
DATE
- left monument as found, lowered monument, removed monument (explain)
- On 5-16-00 placed a 7/8" x 24" REBAR WITH ALUM. CAP
DATE

SKETCH OF REFERENCE TIES

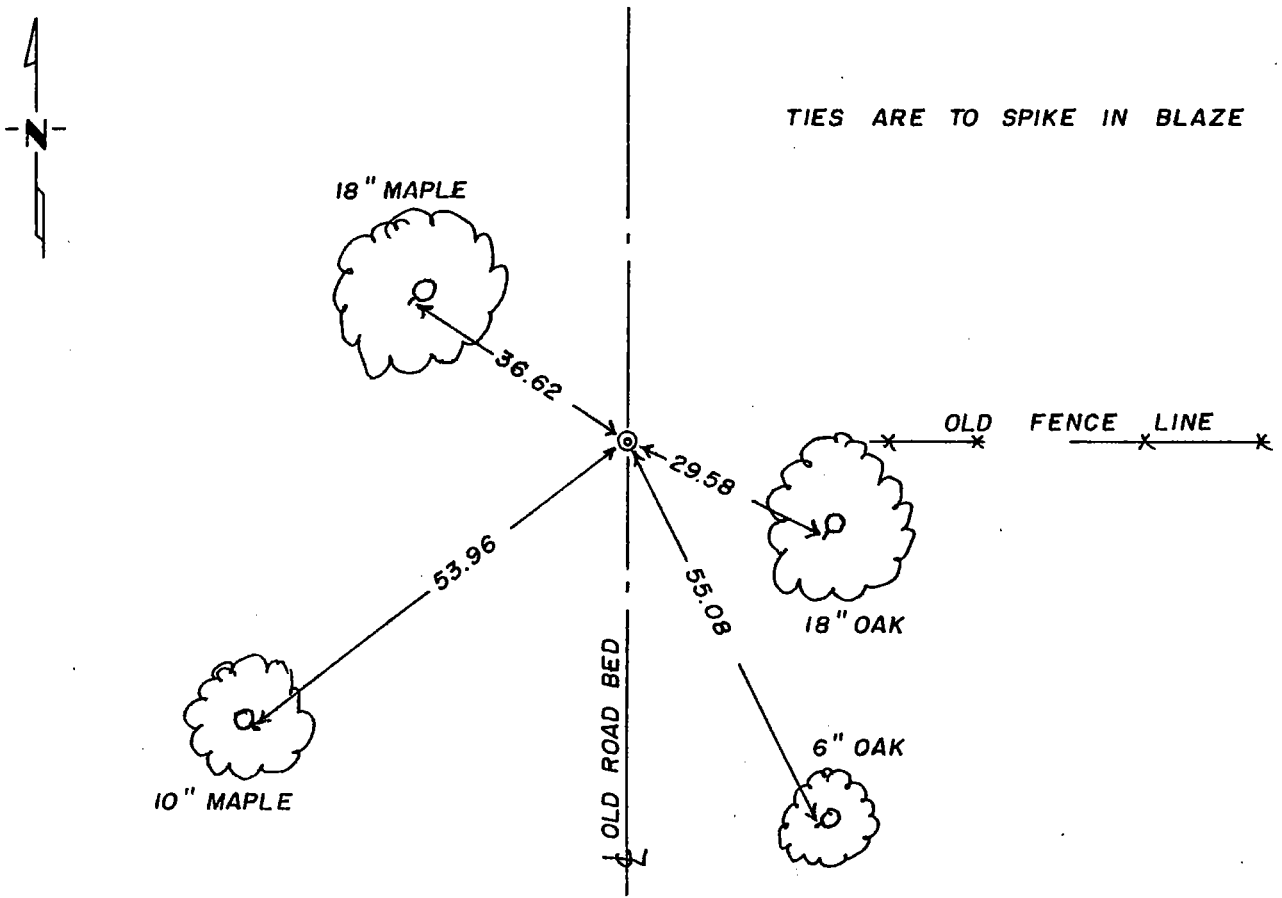

Statement of evidence relative to this corner location is on back of page.

I hereby certify that this document and the data contained herein was prepared by me or under my direct supervision.

SIGNATURE DATE

Registration No. 16091

- Land Surveyor, Professional Engineer
- County Surveyor, County Engineer

OFFICE OF THE COUNTY RECORDER
County of _____

I hereby certify that this document was filed in the Co. Recorders office at _____ .M. on the _____ day of _____ A.D., 19 _____

County Recorder _____

By _____, Deputy

DOCUMENT NO. _____

Statement of Evidence:

OK
M. D. R.
9-14-00

West 1/4 Corner Section 23, Township 42, Range 23

All of the original bearing trees are now gone.

There are no records at the County Court House for this corner.

In May of 2000, we ran a survey along the west line of section 23 to locate existing monuments, lines of occupation and search areas.

There is an old road bed running north-south and an old fence line to the east at this ~~this~~ location. The County Highway Department has an old highway map from the 1930's that shows State Highway No. 5 along the west line of section 23 and turning west along the north line of section 27. We were unable to locate any records of this highway.

An excavation with a back-hoe was made at the fence line and road intersection. (12' x 12' x 2.5' deep) No evidence was found ~~IN THE~~ ~~or the corner location.~~ EXCAVATION

On May 16, 2000 we set a rebar with alum. cap at the intersection of the road centerline and the fence line east as the perpetuated corner location.