

# CERTIFICATE OF LOCATION OF GOVERNMENT CORNER

~~WEST QUARTER~~ Corner of Section ~~19~~, Township 42, Range ~~23~~, 4TH P.M.  
WEST QUARTER Corner of Section 19, Township 42, Range 23, 4TH P.M.

STATE OF MINNESOTA, County of KANABEC

At the corner location shown on the sketch:  
FOUND 4" BY 17" CAST IRON MONUMENT

Kanabec County U.S. Survey Feet Coordinates  
NAD 1983, HARN 1996 Adjustment  
Obtained by RTK GPS Observation

Northing= 238164.07

Easting= 397176.89

Note: NAD 1983, HARN 1996 Adjustment  
coordinates are NOT compatible with  
NAD 1983 coordinates

Note: 1 Meter=3937/1200 U.S. Survey Feet

## SKETCH OF REFERENCE TIES

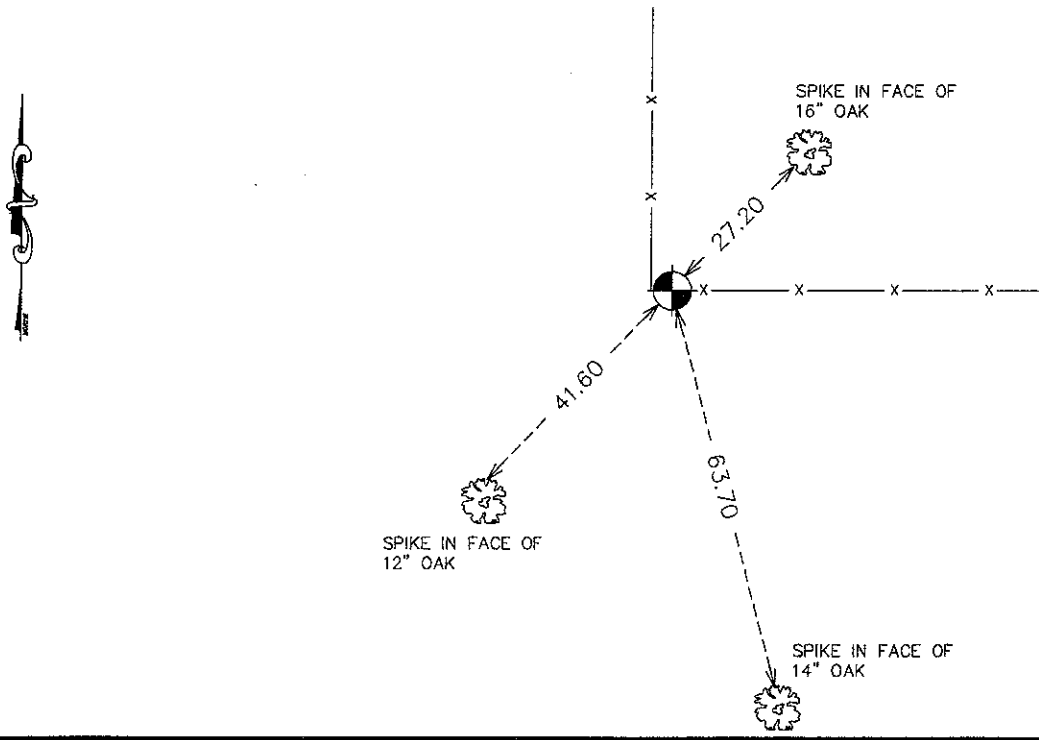

Statement of evidence relative to this corner location is on back of page.

I hereby certify that this document and the data contained herein was prepared by me or under my direct supervision.

Ernest Blund  
Signature

11-27-10  
Date

Registration No. 9808

- Land Surveyor,     Professional Engineer
- County Surveyor,     County Engineer

## OFFICE OF THE COUNTY RECORDER

County of \_\_\_\_\_

I hereby certify that this document was filed in the County Recorder's office at \_\_\_\_\_ M. on the \_\_\_\_\_ day of \_\_\_\_\_ A.D., 20\_\_\_\_

County Recorder \_\_\_\_\_

BY \_\_\_\_\_ Deputy

DOCUMENT NO. \_\_\_\_\_

W1/4 CORNER, SEC. 19, T42, R23  
E1/4 CORNER, SEC. 24, T42, R24

**STATEMENT OF EVIDENCE**

**ALL OF THE ORIGINAL BEARING TREES ARE NOW GON.**

**THERE IS NO SURVEY DATA ON FILE FOR THIS CORNER.**

**THERE IS AN EXISTING FENCE CORNER AT THE E1/4 CORNER OF SEC. 24. THIS FENCE CORNER HAS BEEN MAINTAINED IN ITS ORIGINAL LOCATION PER MR. JOHN SCOTT, THE LAND OWNER OF THE NE1/4 OF SEC. 24. MR. JOHN SCOTT ALSO TESTIFIED THAT THE PREVIOUS LAND OWNER SAID THE FENCE CORNER WAS PLACED AT THE ORIGINAL QUARTER POST LOCATION.**

**M.B. RUDE SET THIS CORNER AT THE CORNER FENCE LOCATION PER MR. JOHN SCOTT'S TESTIMONY.**

**ON MAY 13, 2010, E.G. RUD AND SONS, INC. FOUND THIS CAST IRON MONUMENT AND KANABEC COUNTY COORDINATES WERE ESTABLISHED ON THIS POSITION.**