

CERTIFICATE OF LOCATION OF GOVERNMENT CORNER

West Quarter _____ Corner of Section 6, Township 42, Range 23, 4th P.M.

STATE OF MINNESOTA, County of Kanabec

At the corner location shown on the sketch:

On _____ found a _____
DATE

left monument as found, lowered monument, removed monument (explain)

On 3-5-174 placed a Kanabec County Monument
DATE

SKETCH OF REFERENCE TIES

Ties are to spike in blaze in trees.

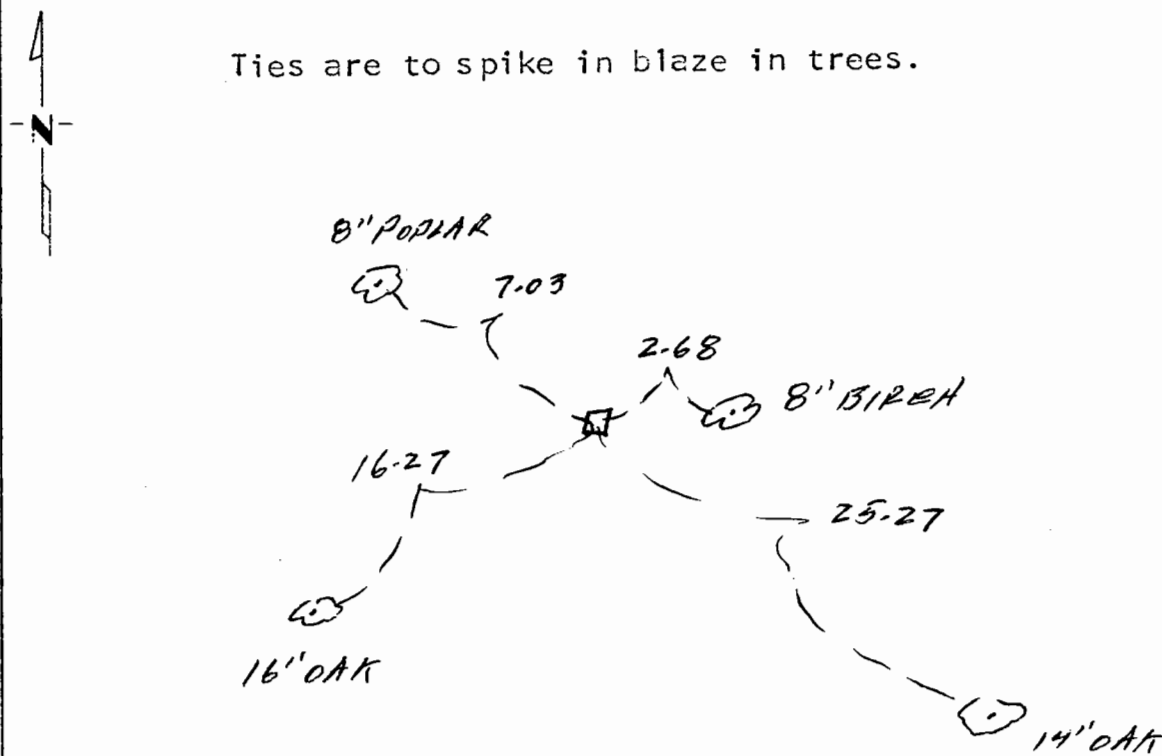

Statement of evidence relative to this corner location is on back of page.

I hereby certify that this document and the data contained herein was prepared by me or under my direct supervision.

Marshall B. Rude 3-22-174
SIGNATURE DATE

Registration No. 8195

- Land Surveyor, Professional Engineer
- County Surveyor, County Engineer

OFFICE OF THE REGISTER OF DEEDS
County of Kanabec

I hereby certify that this document was filed in the Reg. of Deeds office at 3:45 P.M. on the 22 day of April, A.D., 1914

Register of Deeds James H. Nelson
By _____, Deputy

DOCUMENT NO. _____

Statement of Evidence:

Set by single proportional measurement between the Northwest and Southwest corners of Section 6. Fits Government Notes to topographic features well.

No evidence of original corners was found.