

# CERTIFICATE OF LOCATION OF GOVERNMENT CORNER

North Quarter Corner of Section 6, Township 42, Range 23, 4th P.M.

STATE OF MINNESOTA, County of Kanabec

At the corner location shown on the sketch:

On \_\_\_\_\_ found a \_\_\_\_\_  
DATE

left monument as found,  lowered monument,  removed monument (explain)

On 3-5-174 placed a Kanabec County Monument  
DATE

## SKETCH OF REFERENCE TIES



Ties are to spike in blaze in trees.

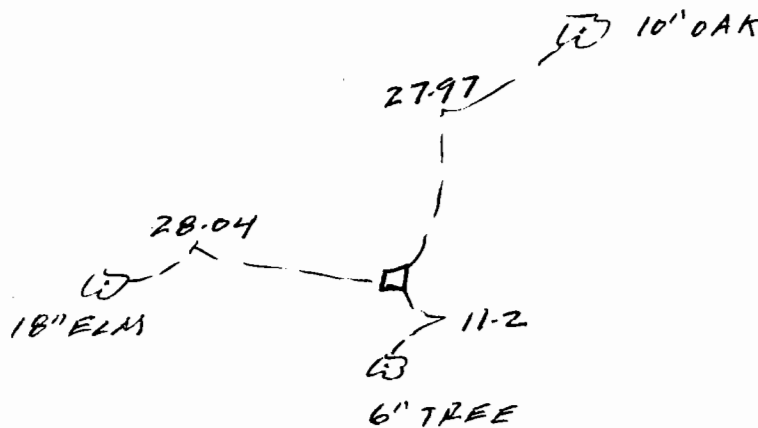

Statement of evidence relative to this corner location is on back of page.

I hereby certify that this document and the data contained herein was prepared by me or under my direct supervision.

Marshall B. Gault 3-22-174  
SIGNATURE DATE

Registration No. 8195

Land Surveyor,  Professional Engineer

County Surveyor,  County Engineer

## OFFICE OF THE REGISTER OF DEEDS

County of Kanabec

I hereby certify that this document was filed in the Reg. of Deeds office at 3:15 P.M. on the 22 day of March A.D., 1921

Register of Deeds Walter C. ...

By \_\_\_\_\_, Deputy

DOCUMENT NO. \_\_\_\_\_

Statement of Evidence:

Set by single proportional measurement between the Northwest and Northeast corners of Section 6.

No evidence of original corner was found.