

CERTIFICATE OF LOCATION OF GOVERNMENT CORNER

~~NE~~ ~~Sec~~ ~~24~~ Corner of Section 24, Township T42, Range 23, 4th P.M.

STATE OF MINNESOTA, County of KANABEC

At the corner location shown on the sketch:

On March 16, 2004 we set a 7/8" x 24" rebar with an aluminium cap

Kanabec County U.S. Survey Feet Coordinates
NAD 1983, HARN 1996 Adjustment
Obtained by RTK GPS Observation

Northing= 240458.244
Easting= 429101.124

Note: NAD 1983, HARN 1996 Adjustment coordinates are NOT compatible with NAD 1983 coordinates
Note: 1 Meter=3937/1200 U.S. Survey Feet

SKETCH OF REFERENCE TIES

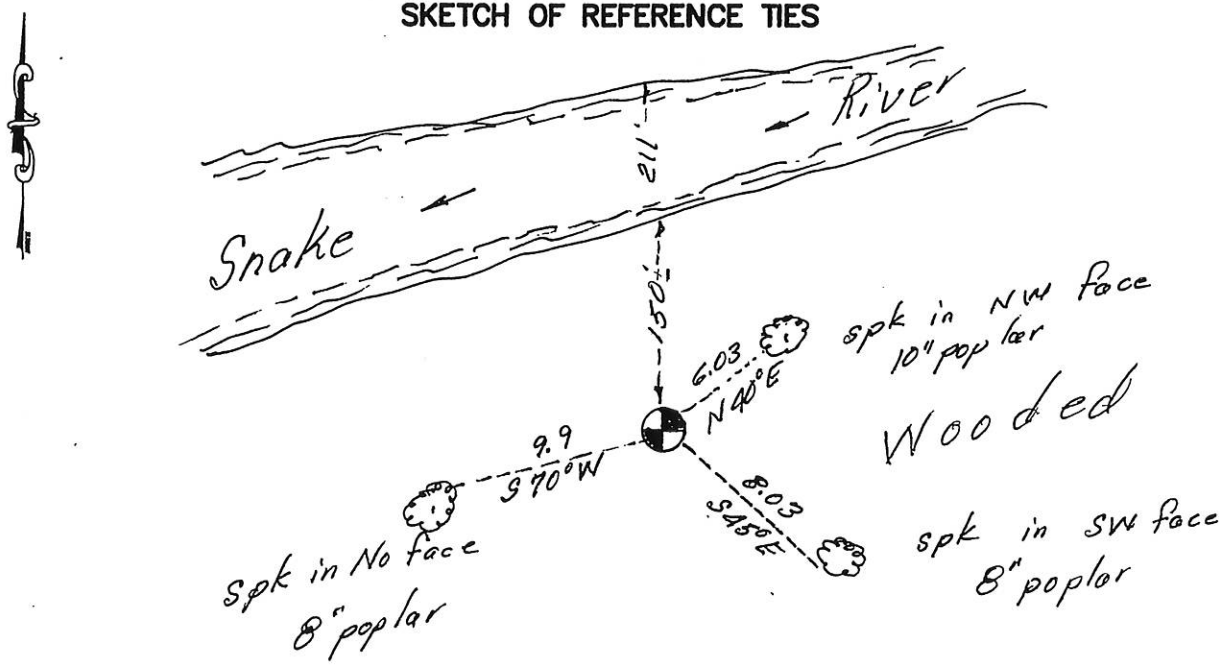

Statement of evidence relative to this corner location is on back of page.

I hereby certify that this document and the data contained herein was prepared by me or under my direct supervision.

Ernest J. Rud May 13, 2014
Signature Date

Registration No. 9808

- Land Surveyor, Professional Engineer
- County Surveyor, County Engineer

OFFICE OF THE COUNTY RECORDER

County of _____

I hereby certify that this document was filed in the County Recorder's office at _____ M. on the

_____ day of _____ A.D., 20__

County Recorder _____

BY _____ Deputy

DOCUMENT NO. _____

Northwest Corner Section 19, Township 42, Range 22

4222031

Northeast Corner Section 24, Township 42, Range 23

4223007

The original Government post was set by U.S. Deputy Surveyor in November, 1849 and 4 bearing trees noted as being;

10" Balsam bearing South 10° West at 38 Links

8" Elm bearing North 45° West at 6 Links

7" Balsam bearing North 60° East at 35 Links

8" Balsam bearing South 8° East at 17 Links

No evidence for post or bearing trees could be found.

This corner falls in a heavily wooded area with no occupation lines in the vicinity. It is approximately 150 feet south of the Snake River. No records of subsequent surveys could be found at Kanabec County Offices or the D.N. R. Therefore we considered this to be a last corner and set it on line and equidistant from the Northeast corner of Section 13 to the Northeast corner of Section 25. A #7 x 24" rebar with an aluminum cap was set, ties were taken and Kanabec County Coordinates established on this position.