

CERTIFICATE OF LOCATION OF GOVERNMENT CORNER

N1/4 Corner of Section 20, Township 39, Range 23, 4TH P.M.

STATE OF MINNESOTA, County of KANABEC

At the corner location shown on the sketch

On _____ found a _____
Date

left monument as found, lowered monument, removed monument (explain)
 On 10-3-95 placed a 7/8" x 24" CAPPED REBAR
Date

SKETCH OF REFERENCE TIES

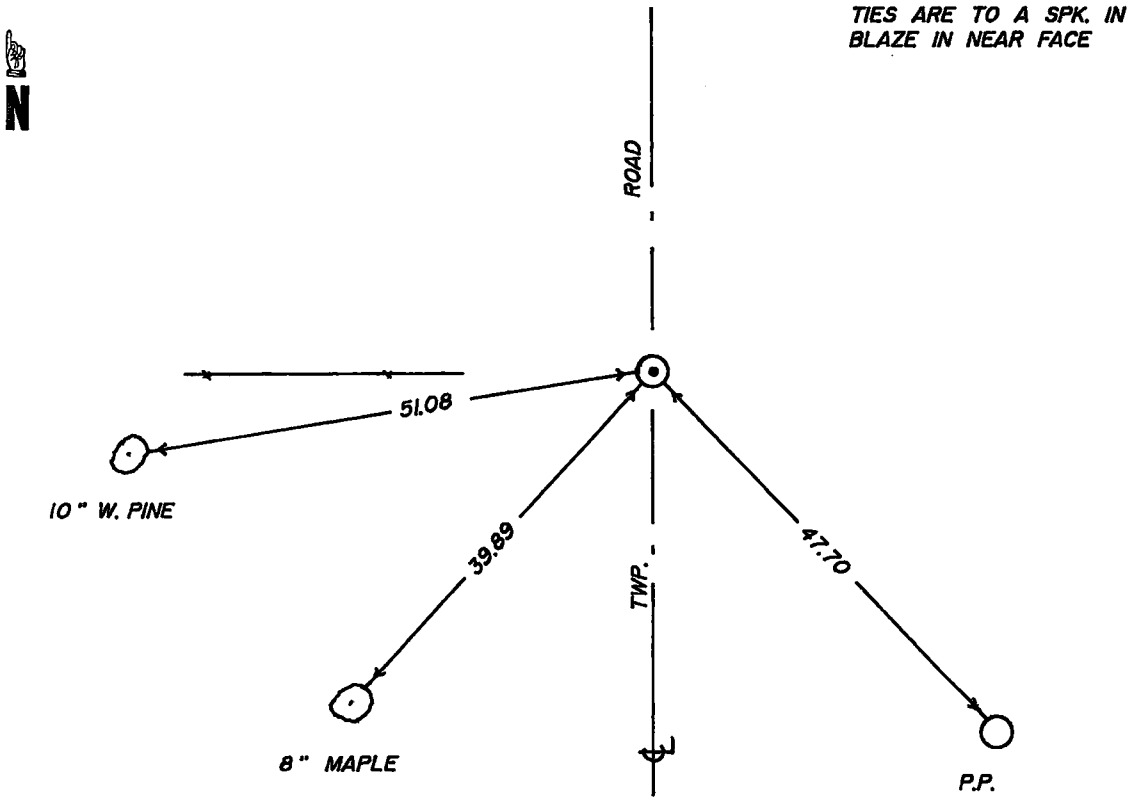

Statement of evidence relative to this corner location is on back of page.

I hereby certify that this document and the data contained herein was prepared by me or under my direct supervision.

[Signature] 12-6-95
Signature Date

Registration No. 8195

Land Surveyor, Professional Engineer
 County Surveyor, County Engineer

County Recorder
OFFICE OF THE REGISTER OF DEEDS

County of Kanabec

I hereby certify that this document was filed in the Register of Deeds office at 2:00 P.M. on the 23rd day of January A.D., 1997
County Recorder
Register of Deeds Rhonda A. Olson

By _____, Deputy

DOCUMENT NO. _____

89

STATEMENT OF EVIDENCE

All of the original government ties are now gone.

In 1897, Thomas Vickery made a section subdivision of Section 20, Township 39, Range 23, and tied into a post at the north quarter corner of Section 20, Township 39, Range 23, per the records at the County Recorder's Office.

In September of 1995, we made a survey in Section 17, Township 39, Range 23, to locate existing monuments, lines of occupation and establish search areas.

On October 3, 1995, we made a 3' by 12' by 14' excavation with a backhoe and found no additional evidence of this corner.

The center line of the existing road and old fence line west, extended east, was accepted as the best available evidence of the original corner location.

This location is in harmony with accepted lines of occupation.