

CERTIFICATE OF LOCATION OF GOVERNMENT CORNER

NORTHEAST Corner of Section 22, Township 39, Range 23, 4TH P.M.
 STATE OF MINNESOTA, County of KANABEC

At the corner location shown on the sketch:
 ON 11/12/2014 FOUND A CAST IRON MONUMENT.

Kanabec County U.S. Survey Feet Coordinates
 NAD 1983, HARN 1996 Adjustment
 Obtained by RTK GPS Observation

Northing= 147752.12
 Easting= 427690.55

Note: NAD 1983, HARN 1996 Adjustment
 coordinates are NOT compatible with
 NAD 1983 coordinates
 Note: 1 Meter=3937/1200 U.S. Survey Feet

SKETCH OF REFERENCE TIES

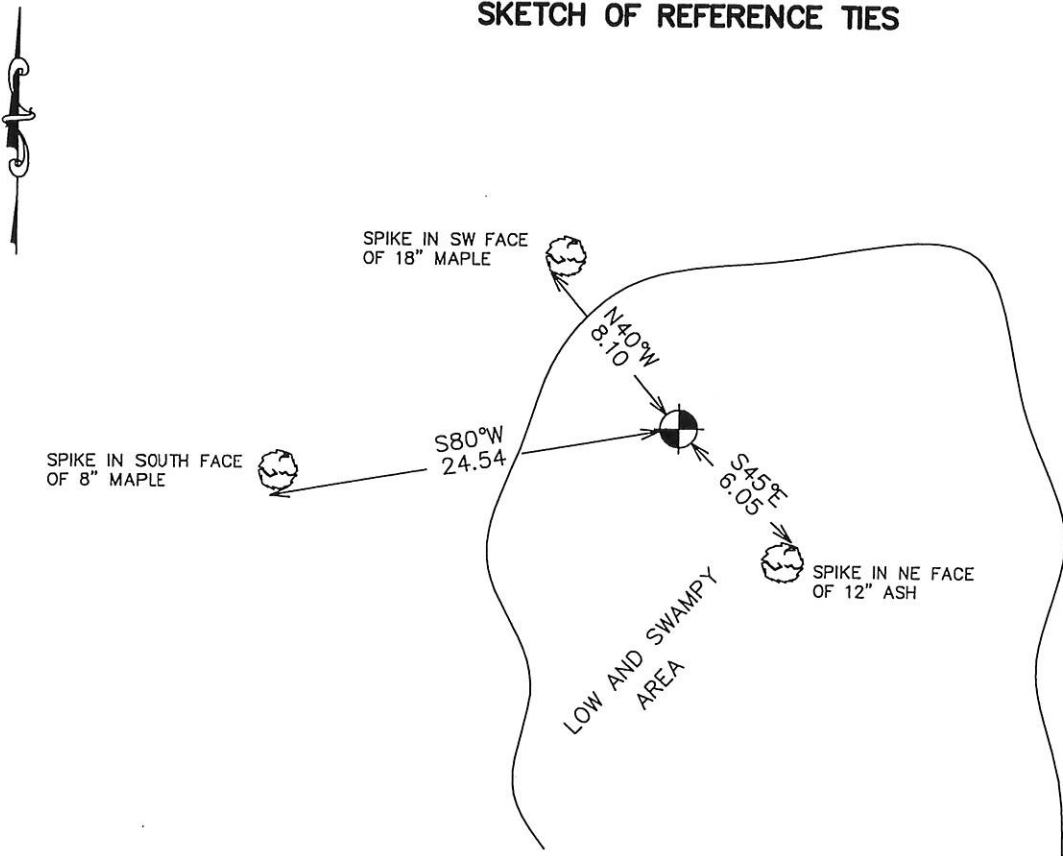

Statement of evidence relative to this corner location is on back of page.

I hereby certify that this document and the data contained herein was prepared by me or under my direct supervision.

Ernest Gud
 Signature

12-10-14
 Date

Registration No. 9808

Land Surveyor, Professional Engineer

County Surveyor, County Engineer

OFFICE OF THE COUNTY RECORDER

County of _____

I hereby certify that this document was filed in the County Recorder's office at _____ M. on the _____ day of _____ A.D., 20__

County Recorder _____

BY _____ Deputy

DOCUMENT NO. _____

STATEMENT OF EVIDENCE

THE ORIGINAL POST WAS SET BY DEPUTY SURVEYOR SILAS BARNARD ON SEPTEMBER 4, 1885 AND 3 BEARING TREES NOTED AS:

**10" OAK BEARING 30°E AT 55 LINKS
12" ELM BEARING SOUTH AT 15 LINKS
12" BURR OAK BEARING WEST AT 165 LINKS**

NO EVIDENCE FOR THE CORNER OR ACCESSORIES REMAIN TODAY.

THERE IS AN UNSIGNED CORNER CERTIFICATE FILED ON PAGE 151 OF CORNER CERTIFICATE BOOK DATED FEBRUARY 17, 1936 WHICH STATES A 3/4 INCH IRON PIN WAS SET AT THE CORNER.

IN 1973 M.B. RUDE DID NOT FIND THIS IRON AND HE SET A CAST IRON MONUMENT AT THE INTERSECTION OF 4 FENCES.

ON NOVEMBER 11, 2014 E.G. RUD AND SONS, INC. FOUND THIS MONUMENT AND ONE REMAINING TIE THAT CHECKED. NEW TIES WERE TAKEN AND KANABEC COUNTY COORDINATES WERE ESTABLISHED ON THIS POSITION.