

CERTIFICATE OF LOCATION OF GOVERNMENT CORNER

NE Corner of Section 23, Township 39, Range 23, 4TH P.M.

STATE OF MINNESOTA, County of KANABEC

At the corner location shown on the sketch:

Set a 1/2" iron pipe from survey data on County Road No. 5

Kanabec County U.S. Survey Feet Coordinates
NAD 1983, HARN 1996 Adjustment
Obtained by RTK GPS Observation

Northing= 147753.60

Easting= 433007.06

Note: NAD 1983, HARN 1996 Adjustment coordinates are NOT compatible with NAD 1983 coordinates

Note: 1 Meter=3937/1200 U.S. Survey Feet

SKETCH OF REFERENCE TIES

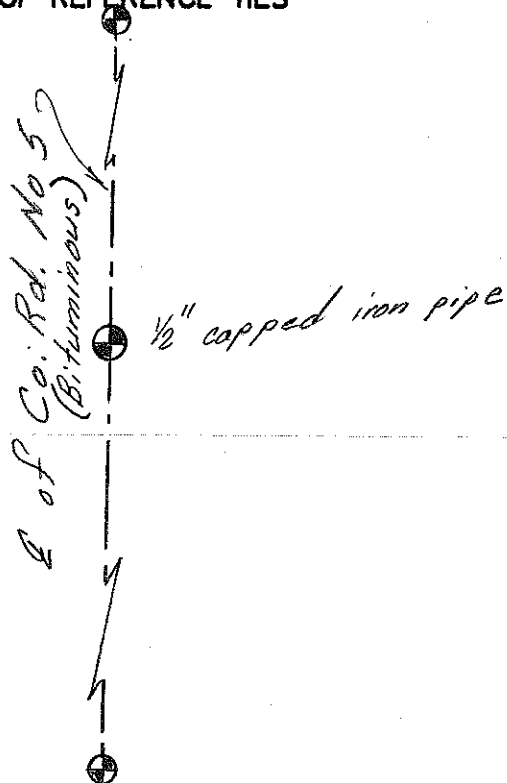

Statement of evidence relative to this corner location is on back of page.

I hereby certify that this document and the data contained herein was prepared by me or under my direct supervision.

Ernest J. Rud
Signature

8-8-12
Date

Registration No. 9808

Land Surveyor, [] Professional Engineer

[] County Surveyor, [] County Engineer

OFFICE OF THE COUNTY RECORDER

County of _____

I hereby certify that this document was filed in the County Recorder's office at _____ M. on the

_____ day of _____ A.D., 20____

County Recorder _____

BY _____ Deputy

DOCUMENT NO. _____

STATEMENT OF EVIDENCE: NORTHEAST CORNER 23-39-23 3923056

In November 1975 M.B. Rude set a monument from old wood hub found in excavation and an iron 8" spike that was set by the County Highway Department. M.B. Rude made a resurvey of County Road No. 5 to find that the position of the hub and the County's spike was good for the corner. Area fits the occupation lines to the East and West and the centerline of the North-South road.

On August 8, 2012 E.G. Rud & Sons in a survey for Section 24 found the monument had been taken out in the reconstruction of County Road 5 and the ties established no longer remained. Therefore the corner was reestablished by the mathematical information computed by M.B. Rude in 1975. This information agreed very well with the established corners. A 1/2" iron pipe was set and Kanabec County coordinates established.
