

CERTIFICATE OF LOCATION OF GOVERNMENT CORNER

Southeast
NORTHEAST Corner of Section 32, Township T40, Range 23, 4TH P.M.

STATE OF MINNESOTA, County of KANABEC

At the corner location shown on the sketch:
IN MARCH 2005 FOUND MONUMENT
AND ESTABLISHED G.P.S. COORDINTES ON THE LOCATION.

Kanabec County U.S. Survey Feet Coordinates
NAD 1983, HARN 1996 Adjustment
Obtained by RTK GPS Observation

Northing= 163827.15
Easting= 417236.67

Note: NAD 1983, HARN 1996 Adjustment
coordinates are NOT compatible with
NAD 1983 coordinates
Note: 1 Meter=3937/1200 U.S. Survey Feet

SKETCH OF REFERENCE TIES

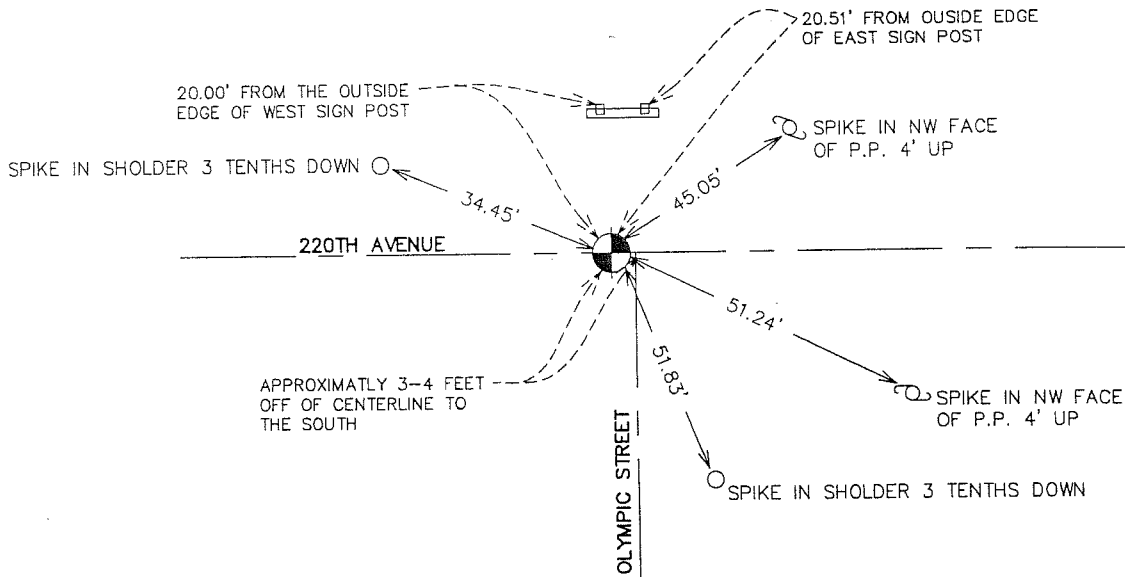

Statement of evidence relative to this corner location is on back of page.

I hereby certify that this document and the data contained herein was prepared by me or under my direct supervision.

Ernest J. Rud 1-23-2006
Signature Date

Registration No. Minn No 9808

Land Surveyor, Professional Engineer
 County Surveyor, County Engineer

OFFICE OF THE COUNTY RECORDER

County of _____

I hereby certify that this document was filed in the County Recorder's office at _____ M. on the _____ day of _____ A.D., 20 _____

County Recorder _____

BY _____ Deputy

DOCUMENT NO. _____

STATEMENT OF EVIDENCE:

THE ORIGINAL CORNER WAS SET BY GOVERNMENT SURVEYOR SILAS BARNARD IN SEPTEMBER 1855. NO EVIDENCE FOR THE CORNER OR BEARING TREES REMAIN.

ON JUNE 7TH 1902 JOHN NELSON MADE A SURVEY OF SECTION 5 AND AT THIS CORNER TOOK TIES TO A SANDSTONE MONUMENT. THE TIES NO LONGER REMAIN.

IN OCTOBER 2005 E.G. RUD AND SONS MAD A SURVEY OF SECTION 5 TO LOCATE EXISTING MONUMENTATION AND TIE IN LINES OF OCCUPATION.

ON OCTOBER 6, 2005 KANABEC COUNTY HIGHWAY DEPARTMENT MADE AN EXCAVATION AT THE CENTERLINE OF AN EAST WEST GRAVEL ROAD AND CENTERLINE OF GRAVEL ROAD GOING SOUTH. THE EXCAVATION WAS 2.5 FEET WIDE BY 10 FEET LONG BY 1 FOOT DEEP. WE FOUND A LARGE SANDSTONE (APPROXIMATELY 12" BY 18") WITH A FLAT SURFACE WITH AN "X" CARVED IN THE TOP. WE TOOK NEW TIES AND SET A #7 REBAR 24" LONG WITH AN ALUMINUM CAP AT THIS LOCATION. KANABEC COUNTY COORDINATES WERE ESTABLISHED USING G.P.S. EQUIPMENT.