

# CERTIFICATE OF LOCATION OF GOVERNMENT CORNER

EAST 1/4 Corner of Section 12, Township 39, Range 23, 4TH P.M.

STATE OF MINNESOTA, County of KANABEC

At the corner location shown on the sketch:

IN MARCH 2005 FOUND CAST IRON MONUMENT AND ESTABLISHED GPS COORDINATES.

Kanabec County U.S. Survey Feet Coordinates  
NAD 1983, HARN 1996 Adjustment  
Obtained by RTK GPS Observation

Northing= 155736.72

Easting= 438274.21

Note: NAD 1983, HARN 1996 Adjustment  
coordinates are NOT compatible with  
NAD 1983 coordinates

Note: 1 Meter=3937/1200 U.S. Survey Feet

SKETCH OF REFERENCE TIES  
FROM TIE SHEET 939

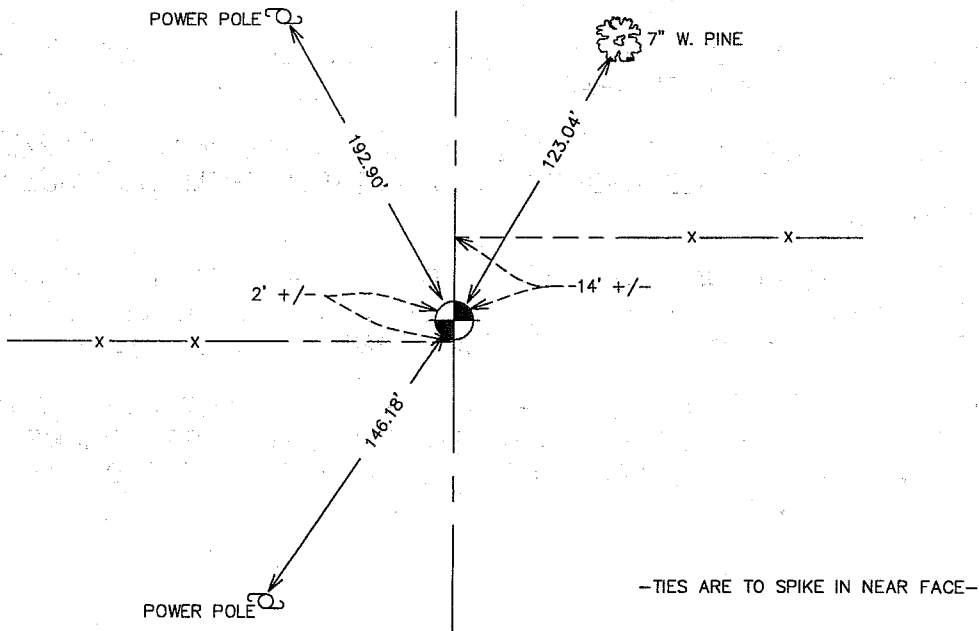

Statement of evidence relative to this corner location is on back of page.

I hereby certify that this document and the data contained herein was prepared by me or under my direct supervision.

*Ernest J. Rud*  
Signature

11-09-2005  
Date

Registration No. *Minn # 9800*

## OFFICE OF THE COUNTY RECORDER

County of \_\_\_\_\_

I hereby certify that this document was filed in the County Recorder's office at \_\_\_\_\_ M. on the

\_\_\_\_\_ day of \_\_\_\_\_ A.D., 20\_\_\_\_

County Recorder \_\_\_\_\_

BY \_\_\_\_\_ Deputy

Land Surveyor,  Professional Engineer

## STATEMENT OF EVIDENCE

ALL OF THE ORIGINAL BEARING TREES ARE NOW GONE.

IN 1907, JON MULLEN MADE A ROAD SURVEY ALONG THE WEST LINE OF SECTION 7. THIS OWN ROAD SURVEY SHOWS THAT HE DID NOT FIND THE QUARTER CORNER AND RAN A STRAIGHT LINE FROM THE NORTHWEST TO THE SOUTHWEST CORNERS OF SECTION 7.

THE RECORDS OF THE FORMER COUNTY SURVEYOR, JAMES BUCKLEY, DATED IN 1927, SHOW A DISTANCE FROM THE SOUTHWEST CORNER TO THE WEST QUARTER CORNER OF SECTION 7, BUT NO MONUMENT IS SHOWN AT THE WEST QUARTER CORNER.

IN OCTOBER OF 1987, M.B. RUDE RAN A SURVEY ALONG THE WEST LINE OF TOWNSHIP 39, RANGE 22, TO LOCATE THE EXISTING MONUMENTS, LINES OF OCCUPATION AND SEARCH AREAS.

THIS CORNER LOCATION IS IN COUNTY HIGHWAY NO. 120 AND THERE IS A FENCE LINE EAST AND WEST 16 FEET APART.

ON OCTOBER 27, 1987, M.B. RUDE MADE AN EXCAVATION WITH THE BACKHOE AT BOTH FENCE LINES EXTENDED AND THE AREA BETWEEN THEM. NO EVIDENCE WAS FOUND IN THE EXCAVATION.

M.B. RUDE SET THIS CORNER ON A LINE AND SPLIT BETWEEN THE NORTHWEST AND SOUTHWEST CORNERS OF SECTION 7. THIS LOCATION FITS THE CENTER LINE OF THE ROAD AND IS IN HARMONY WITH THE TOWN ROAD SURVEY OF 1907.

IN MARCH 2005 E.G. RUD AND SONS FOUND THIS MONUMENT AND ESTABLISHED KANABEC COUNTY COORDINATES ON THIS POSITION USING GPS EQUIPMENT. THIS POSITION IS WITHIN 0.20 OF A FOOT FROM A LINE AND SPLIT FROM NE AND SE CORNERS OF SECTION 12.