

CERTIFICATE OF LOCATION OF GOVERNMENT CORNER

NORTHEAST Corner of Section 36, Township 39, Range 23, 4TH P.M.
 STATE OF MINNESOTA, County of KANABEC

At the corner location shown on the sketch:
 IN MARCH 2005 FOUND THIS MONUMENT
 AND ESTABLISHED G.P.S. COORDINATES ON ITS LOCATION.

Kanabec County U.S. Survey Feet Coordinates
 NAD 1983, HARN 1996 Adjustment
 Obtained by RTK GPS Observation

Northing= 137270.21
 Easting= 438256.06

Note: NAD 1983, HARN 1996 Adjustment
 coordinates are NOT compatible with
 NAD 1983 coordinates
 Note: 1 Meter=3937/1200 U.S. Survey Feet

SKETCH OF REFERENCE TIES

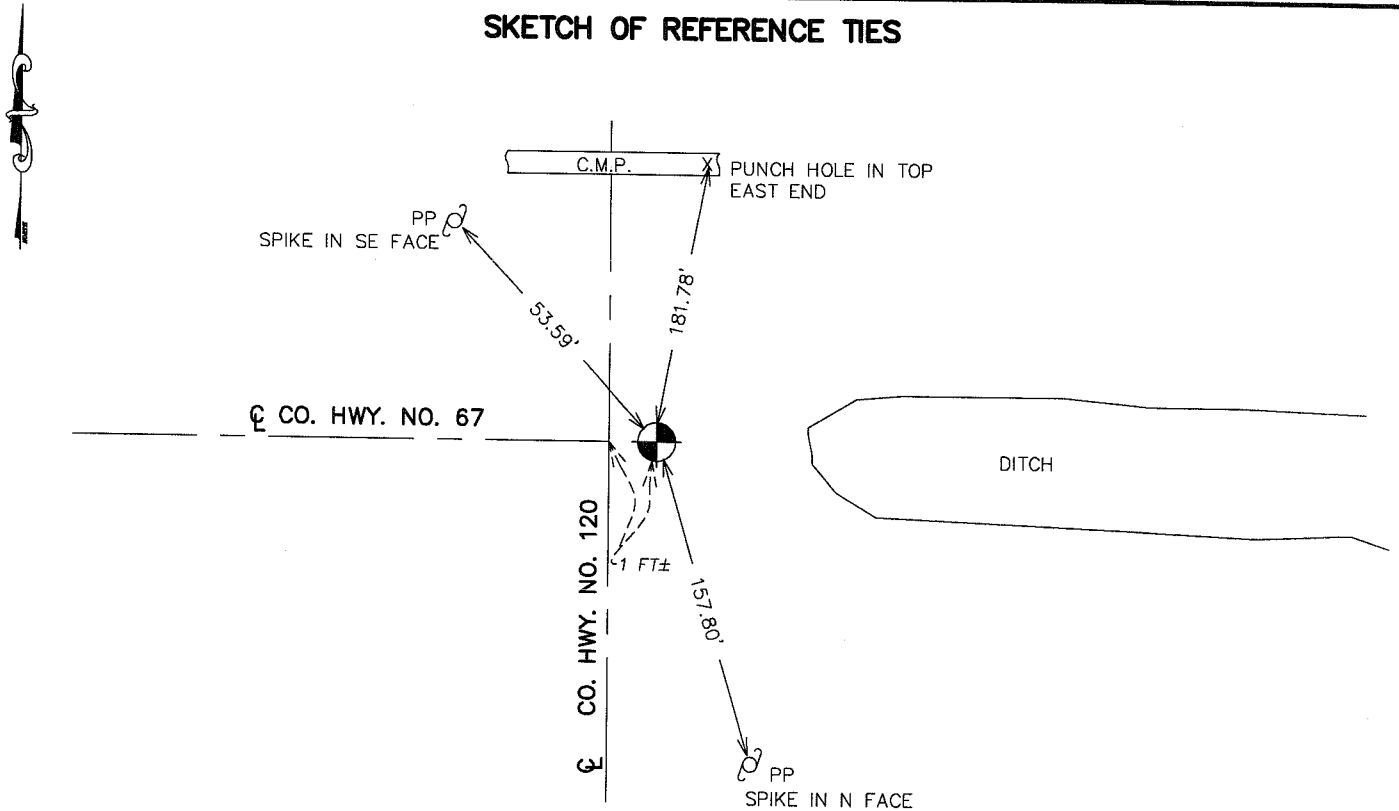

Statement of evidence relative to this corner location is on back of page.

I hereby certify that this document and the data contained herein was prepared by me or under my direct supervision.

Ernest J. Hud 11-18-2005
 Signature Date

Registration No. Minn No 9808

Land Surveyor, Professional Engineer
 County Surveyor, County Engineer

OFFICE OF THE COUNTY RECORDER

County of _____

I hereby certify that this document was filed in the County Recorder's office at _____ M. on the _____ day of _____ A.D., 20____

County Recorder _____

BY _____ Deputy

DOCUMENT NO. _____

STATEMENT OF EVIDENCE

ALL OF THE ORIGINAL BEARING TREES ARE NOW GONE.

JOHN NELSON, THE KANABEC COUNTY SURVEYOR'S RECORDS SHOW HE USED HIS CORNER IN 1903, BUT DOES NOT SHOW WHAT WAS FOUND OR SET.

IN APRIL OF 1981, M.B. RUDE RAN A SURVEY AROUND SECTION 30 AND LOCATED THE LINES OF OCCUPATION AND THE EXISTING MONUMENTS.

THIS CORNER IS AT THE INTERSECTION OF ROADS NORTH, SOUTH AND WEST AND THE DITCH EAST.

ON MAY 5, 1981, M.B. RUDE MADE AN EXCAVATION WITH A BACKHOE AT THIS LOCATION. THE EXCAVATION WAS 15 FEET SQUARE, 3 FEET DEEP.

AT 1.5 FEET BELOW THE SURFACE, AN OLD HEAVY DUTY WAGON WHEEL HUB WAS FOUND.

M.B. RUDE ACCEPTED THE WAGON WHEEL HUB AS THE BEST AVAILABLE EVIDENCE OF THE ORIGINAL CORNER LOCATION.

M.B. RUDE OFFSET THE WAGON WHEEL HUB, BACKFILLED THE EXCAVATION AND SET A 4" BY 17" CAST IRON MONUMENT TO MARK THIS CORNER.

IN MARCH 2005 E.G. RUD AND SONS FOUND THIS MONUMENT AND ESTABLISHED KANABEC COUNTY COORDINATES ON THIS POSITION USING G.P.S. EQUIPMENT.