

CERTIFICATE OF LOCATION OF GOVERNMENT CORNER

SE cor
EAST 1/4 Corner of Section 36, Township 39, Range 23, 4TH P.M.

STATE OF MINNESOTA, County of KANABEC

At the corner location shown on the sketch:
 In March 2005 found this monument.

Kanabec County U.S. Survey Feet Coordinates
 NAD 1983, HARN 1996 Adjustment
 Obtained by RTK GPS Observation

Northing= 129275.27

Easting= 438267.99

Note: NAD 1983, HARN 1996 Adjustment
 coordinates are NOT compatible with
 NAD 1983 coordinates

Note: 1 Meter=3937/1200 U.S. Survey Feet

SKETCH OF REFERENCE TIES

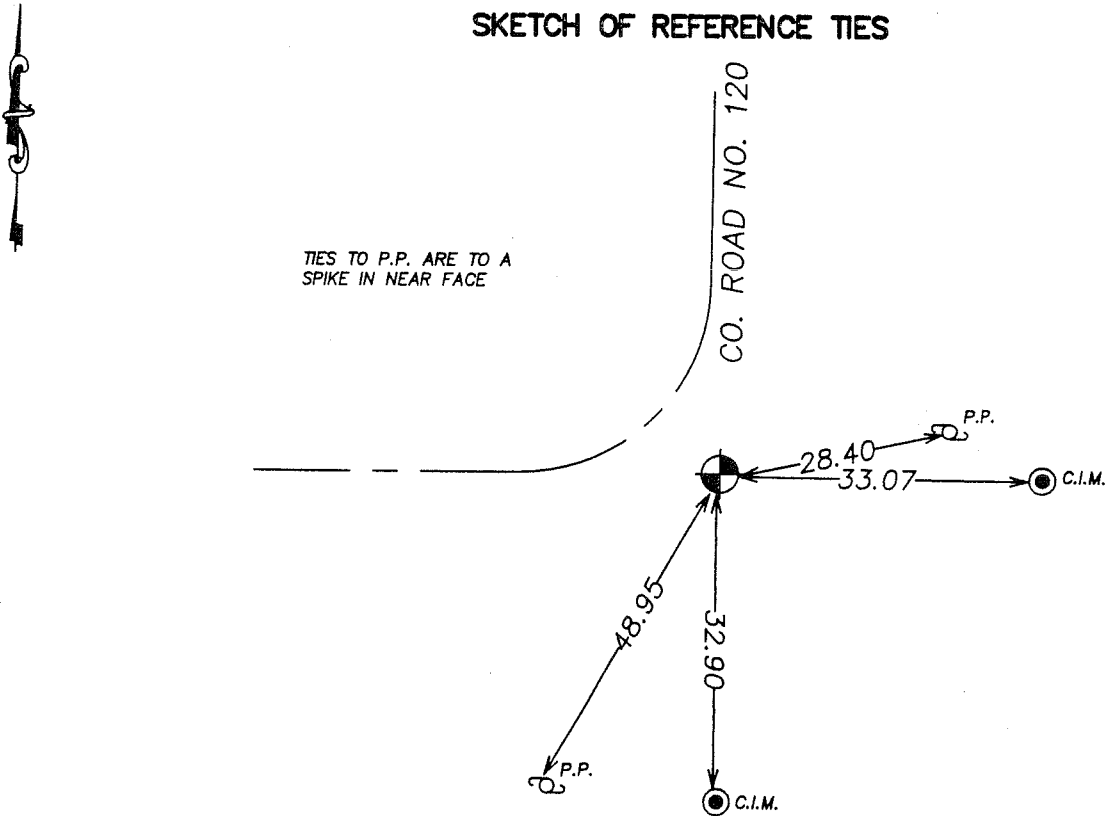

Statement of evidence relative to this corner location is on back of page.

I hereby certify that this document and the data contained herein was prepared by me or under my direct supervision.

Ernest L Reed 10-17-2005
 Signature Date

Registration No. Minn No 9808

Land Surveyor, Professional Engineer
 County Surveyor, County Engineer

OFFICE OF THE COUNTY RECORDER

County of _____

I hereby certify that this document was filed in the County Recorder's office at _____ M. on the _____ day of _____ A.D., 20____

County Recorder _____

BY _____ Deputy

DOCUMENT NO. _____

STATE OF EVIDENCE 1991

M.B. RUDE FOUND A SANDSTONE WITH A HOLE IN THE CENTER PER THE CERTIFICATE ON FILE AT THE COUNTY RECORDER'S OFFICE. WE REPLACED IT WITH A CAPPED REBAR AND ESTABLISHED NEW REFERENCE TIES.

IN MARCH 2005 E.G. RUD AND SONS FOUND THIS MONUMENT AND ESTABLISHED KANABEC COUNTY COORDINATES ON THIS POSITION USING GPS EQUIPMENT.