

CERTIFICATE OF LOCATION OF GOVERNMENT CORNER

NORTH QUARTER Corner of Section 23, Township 38, Range 24, 4TH P.M.
 STATE OF MINNESOTA, County of KANABEC

At the corner location shown on the sketch:
 On 05/ /2003 Found a Kanabec County Monument.

Kanabec County U.S. Survey Feet Coordinates
 NAD 1983, HARN 1996 Adjustment
 Obtained by RTK GPS Observation

Northing= 116554.458

Easting= 398720.073

Note: NAD 1983, HARN 1996 Adjustment
 coordinates are NOT compatible with
 NAD 1983 coordinates

Note: 1 Meter=3937/1200 U.S. Survey Feet

SKETCH OF REFERENCE TIES *from tie sheet 916*

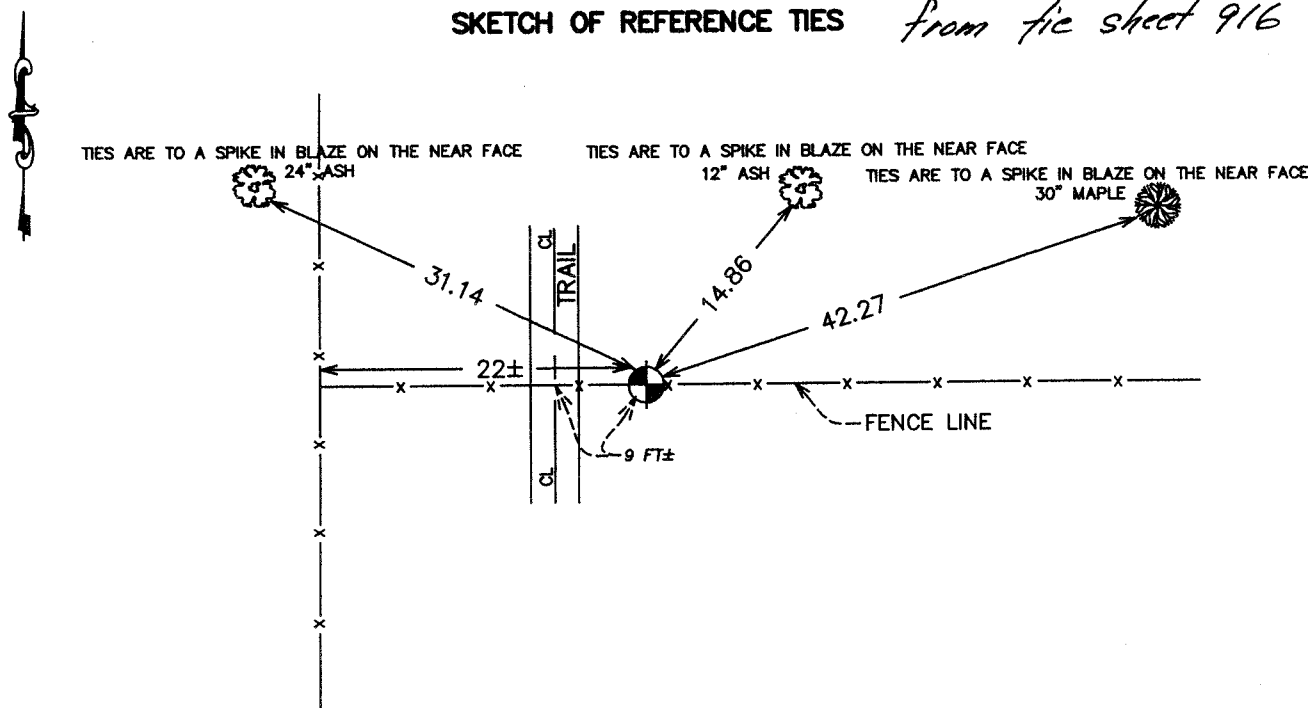

Statement of evidence relative to this corner location is on back of page.

I hereby certify that this document and the data contained herein was prepared by me or under my direct supervision.

Ernest Reed 5-19-2004
Signature Date

Registration No. 9808

- Land Surveyor, Professional Engineer
 County Surveyor, County Engineer

OFFICE OF THE COUNTY RECORDER

County of _____

I hereby certify that this document was filed in the County Recorder's office at _____ M. on the _____ day of _____ A.D., 20____

County Recorder _____

BY _____ Deputy

DOCUMENT NO. _____

STATEMENT OF EVIDENCE
(FROM TIE SHEET 916)

All of the original government bearing trees are now gone.

In January of 1995, we ran a survey around Section 14, Township 38, Range 24, to locate existing monuments, lines of occupation and search areas.

This corner falls in the location of an east-west-north-south fence.

A search was made in this area, but no evidence was found.

We extended the line from the north quarter corner through the found stone with the cross mark at the center of Section 14 and found the location to be within 1 foot of a split of the north line of Section 23.

The location of this line intersected with the east-west fence was accepted as the best available evidence of the perpetuated location of the original corner.

(2003)

In May 2003, we ran a survey around Section 14 and found the monument set by M.B. Rude. We established Kanabec County coordinates on this corner using G.P.S. equipment.