

# CERTIFICATE OF LOCATION OF GOVERNMENT CORNER

EAST QUARTER Corner of Section 23, Township 38, Range 24, 4TH P.M.

STATE OF MINNESOTA, County of KANABEC

At the corner location shown on the sketch:  
On 06/26/2003 Set a Kanabec County Monument.

Kanabec County U.S. Survey Feet Coordinates  
NAD 1983, HARN 1996 Adjustment  
Obtained by RTK GPS Observation

Northing= 113842.591

Easting= 401344.110

Note: NAD 1983, HARN 1996 Adjustment  
coordinates are NOT compatible with  
NAD 1983 coordinates

Note: 1 Meter=3937/1200 U.S. Survey Feet

### SKETCH OF REFERENCE TIES

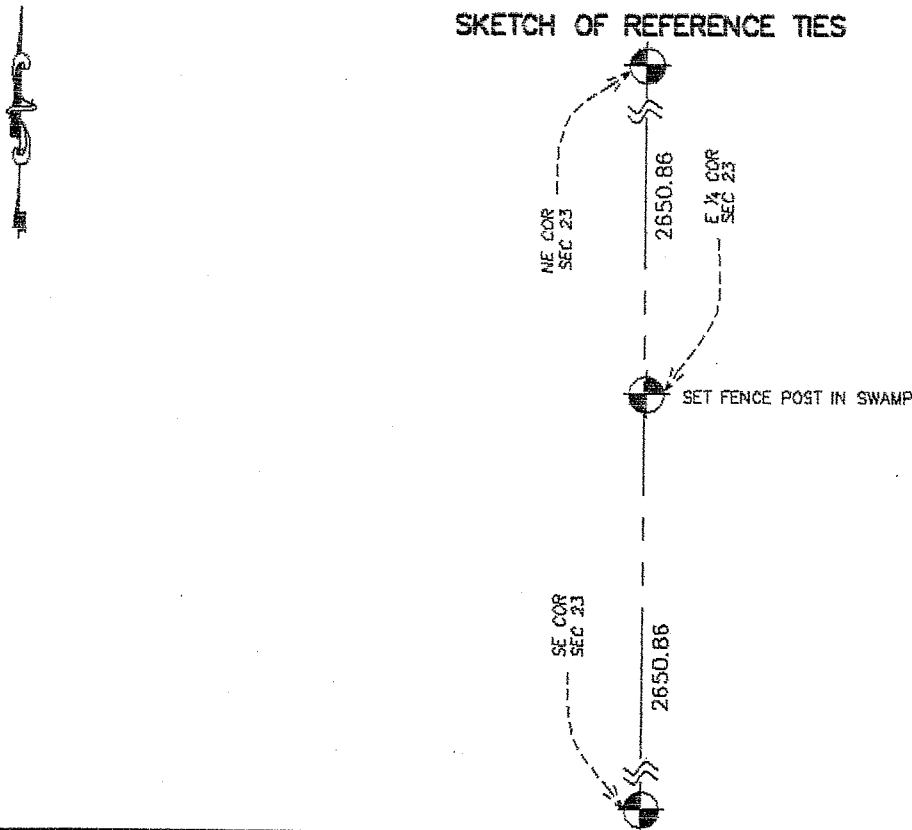

Statement of evidence relative to this corner location is on back of page.

I hereby certify that this document and the data contained herein was prepared by me or under my direct supervision.

*Ernest J. Rud*  
Signature

8-08-2003  
Date

Registration No. 9808

- Land Surveyor,       Professional Engineer  
 County Surveyor,     County Engineer

### OFFICE OF THE COUNTY RECORDER

County of \_\_\_\_\_

I hereby certify that this document was filed in the County Recorder's office at \_\_\_\_\_ M. on the

\_\_\_\_\_ day of \_\_\_\_\_ A.D., 20\_\_

County Recorder \_\_\_\_\_

BY \_\_\_\_\_ Deputy

DOCUMENT NO. \_\_\_\_\_

## STATEMENT OF EVIDENCE

Original corner was set by Silas Barnard in 1855. No evidence of original corner or bearing trees remain.

In Book 2 of Surveys, Page 303 a survey of Section 23 dated May 7, 1901 by John Nelson is recorded. On this survey John shows he set a post for the East Quarter corner and took two ties to tamarack trees. This corner falls in a tamarack swamp which had 2 feet of water in it on June 26, 2003.

In June 2003 we made a survey of Sections 22, 23, 26, 27, 28, 33, and 34 to locate corners and tie in occupation lines.

On June 26, 2003 we made an extensive search for the John Nelson post and ties, but could not find it.

John Nelson recorded a distance of 5299.80 feet in 1901 and we measured 5301.72 feet. We treated this as a lost corner and set one on line and equidistant from the Northeast and Southeast corner of Section 23.