

CERTIFICATE OF LOCATION OF GOVERNMENT CORNER

NORTH QUARTER Corner of Section 31, Township 39, Range 24, 4TH P.M.

STATE OF MINNESOTA, County of KANABEC

At the corner location shown on the sketch:
SET A MAG NAIL IN CONCRETE SURFACE.

Kanabec County U.S. Survey Feet Coordinates
NAD 1983, HARN 1996 Adjustment
Obtained by RTK GPS Observation

Northing= 137369.51

Easting= 377845.81

Note: NAD 1983, HARN 1996 Adjustment
coordinates are NOT compatible with
NAD 1983 coordinates

Note: 1 Meter=3937/1200 U.S. Survey Feet

SKETCH OF REFERENCE TIES

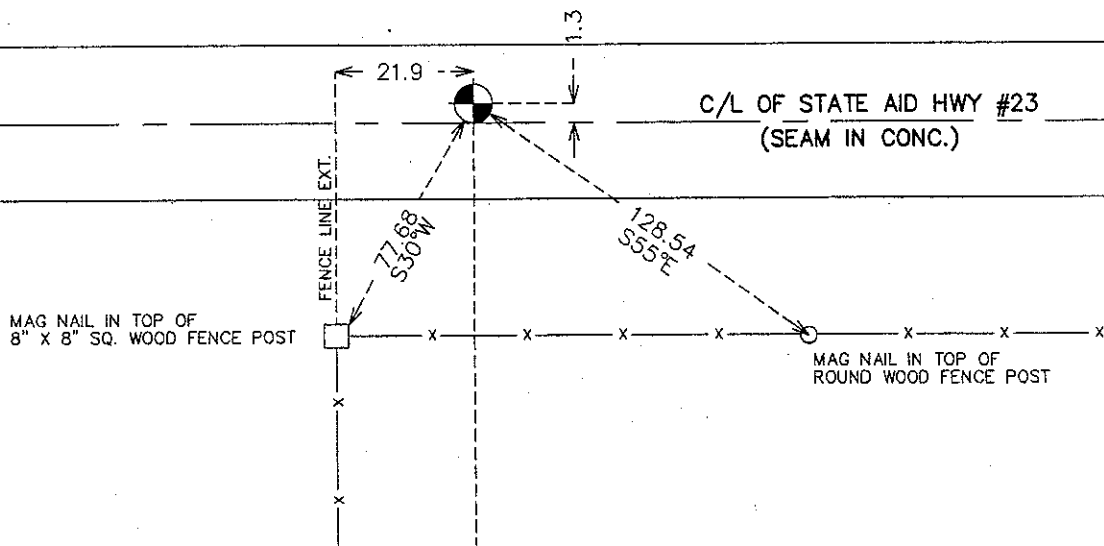

Statement of evidence relative to this corner location is on back of page.

I hereby certify that this document and the data contained herein was prepared by me or under my direct supervision.

Ernest Glud
Signature

1-1-13
Date

Registration No. 9808

- Land Surveyor, Professional Engineer
 County Surveyor, County Engineer

OFFICE OF THE COUNTY RECORDER

County of _____

I hereby certify that this document was filed in the County Recorder's office at _____ M. on the _____ day of _____ A.D., 20____

County Recorder _____

BY _____ Deputy

DOCUMENT NO. _____

North Quarter Corner Section 31, Township 39, Range 24

Original Government post was set by Deputy Surveyor Silas Barnard on October 4, 1855 and two bearing trees noted as:

11" Sugar Maple bearing South 48° West at 50 links

15" Pine bearing North 50° East at 25 links

No visible evidence remains today for the corner Government post or accessories. Government chainage along no line of Section 31 = 77.25 chains or 5098.5 feet. In book 1 of 2 of surveys, page 5 John Nelson recorded a survey for the South line of Section 30 and established Southwest, Southeast, and South Quarter corners of Section 30. At that time he recorded the measured distance along this line to be 77.82 chains or 5136.12 feet.

In book 2 of 2 of survey page 33 John Nelson recorded a survey dated September 29, 1904 for Section 31. At that time he recorded the distance along the North line of Section 31 to be 78.94 chains or 5210.04 feet, 74 feet longer than 3 years previously. He stated all section corners to be in and that he set Quarter corners at Government chainage distances.

In the 1950's M.H.D. recorded a total distance 5142.8 feet when survey Highway 23 was run. A distance of 2667.4 feet was recorded from the Northeast corner of Section 31 to a fence running South at the North Quarter corner of Section 31. From this fence to the Northwest corner of Section 31 a distance of 2475.4 feet was recorded.

Today we measured 5149.47 feet from Northeast to Northwest corners of Section 31. A breakdown of prorated distances from the Northeast corner to the North Quarter corner is as follows:

Government Survey- $5149.47 \text{ feet} / 77.25 \text{ chains} = 2666.39$

Nelson 1901- $5149.47 \text{ feet} / 77.82 \text{ chains} \times 40 = 2646.86$

Nelson 1904 Survey- $5149.47 \text{ feet} / 78.94 \text{ chains} \times 40 = 2609.31$

State Highway Survey- 2667.4 feet from North Quarter Corner to Northeast Corner

Therefore we set a monument on line and at a prorated distance using Government chainage between the Northeast and Northwest corners of Section 31. This fell 1.3 feet North of the centerline of T.H. 23 and 22 feet East of a fence running South. The fence corner at the center of Section 31 fell 1.3 feet North and 0.7' West of the computed center. There were no good lines of occupation at the center of Section 30.