

# CERTIFICATE OF LOCATION OF GOVERNMENT CORNER

W. 1/4 Corner of Section 14, Township 39, Range 24, 4<sup>TH</sup> P.M.

STATE OF MINNESOTA, County of KANABEC

At the corner location shown on the sketch

On \_\_\_\_\_ found a \_\_\_\_\_  
Date

left monument as found,  lowered monument,  removed monument (explain)  
 On 9 - 21 - 82 placed a 4" x 17" C.I.M.  
Date

### SKETCH OF REFERENCE TIES

TIES ARE TO SPK. IN  
BLAZE IN NEAR FACE

**N**

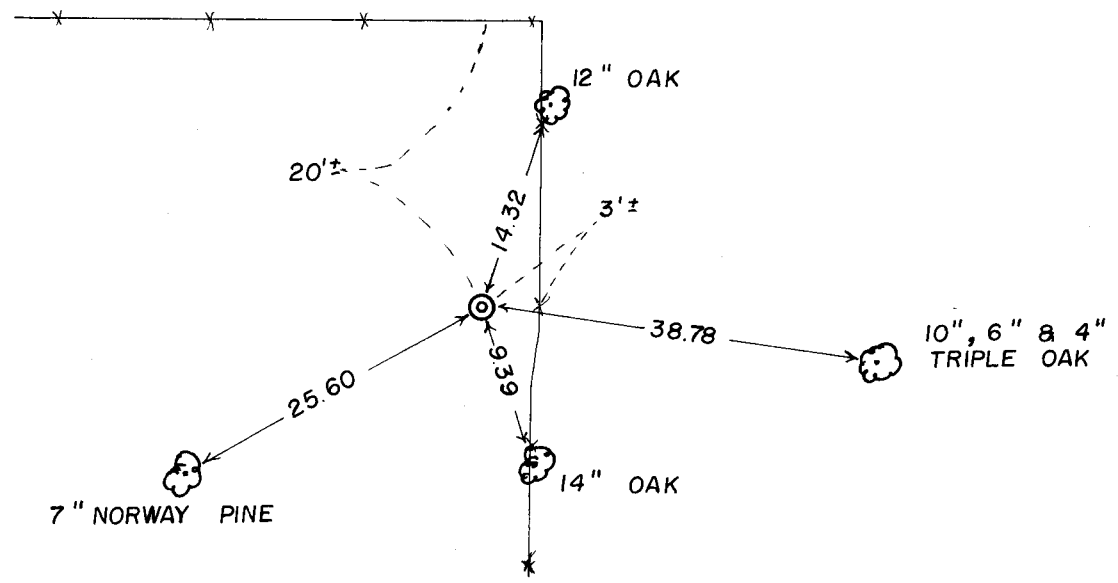

35/71

Statement of evidence relative to this corner location is on back of page.

I hereby certify that this document and the data contained herein was prepared by me or under my direct supervision.

M. A. Bull Signature 9-27-82 Date

Registration No. 8195

Land Surveyor,  Professional Engineer  
 County Surveyor,  County Engineer

*County Recorder*  
OFFICE OF THE REGISTER OF DEEDS

County of Kanabec

I hereby certify that this document was filed in the ~~Register of Deeds~~ office at 10:45 A.M. on the 20 day of October A.D., 1982

*County Recorder*  
~~Register of Deeds~~ Velma J. Besser

By \_\_\_\_\_, Deputy

DOCUMENT NO. \_\_\_\_\_

## STATEMENT OF EVIDENCE

All of the original bearing trees are now gone.

John Nelson, the County Surveyor, made a survey in Section 15, Township 39, Range 24, in 1902, and found this corner and took ties to a 12" oak and a pine. These ties are now gone.

In 1959, N. C. Hioum, a Registered Land Surveyor, found an iron pipe at the center of Section 14 in a survey for RIVERSIDE ADDITION, and in 1970 filed a Certificate of Location of Government Corner at this location. This corner has been used in the subdivision of the east half of Section 14. We found Hoium's center of section.

Gerald Sullivan, a Registered Land Surveyor, found a square pin in 1969 purported to be on the west line of Section 14 and the center line of Bean Avenue. We found Sullivan's square pin.

We extended the line south from the northwest corner of Section 14 through Sullivan's pin and intersected it with a line from the East Quarter Corner of Section 14 through Hoium's center of the section and accepted this point of intersection as the best available evidence of the original corner location. We set a 4" by 17" cast iron monument to mark this corner.

The existing subdivision lines in the Northwest Quarter of Section 14 do not fit a proper section subdivision. The west quarter corner could not be placed as to fit the existing subdivision lines in the Northwest Quarter and also fit the existing center of section and subdivision lines in the East Half of Section 14. The west quarter corner was set to fit the existing center of section so that the proper section subdivision will fit what has been used in the Northeast Quarter and Southeast Quarter of Section 14 and the irregular subdivision is confined to only the Northwest Quarter. The subdivision lines in the Northwest Quarter are well monumented with existing plats which should control these lines.