

CERTIFICATE OF LOCATION OF GOVERNMENT CORNER

EAST QUARTER Corner of Section 23, Township 39, Range 24, 4TH P.M.

STATE OF MINNESOTA, County of KANABEC

At the corner location shown on the sketch:
IN JUNE 2009 FOUND A KANABEC COUNTY MONUMENT

Kanabec County U.S. Survey Feet Coordinates
NAD 1983, HARN 1996 Adjustment
Obtained by RTK GPS Observation

Northing= 142288.69

Easting= 401469.57

Note: NAD 1983, HARN 1996 Adjustment
coordinates are NOT compatible with
NAD 1983 coordinates

Note: 1 Meter=3937/1200 U.S. Survey Feet

SKETCH OF REFERENCE TIES FROM TIE SHEET 287

TIES ARE TO SPIKE IN NEAR FACE

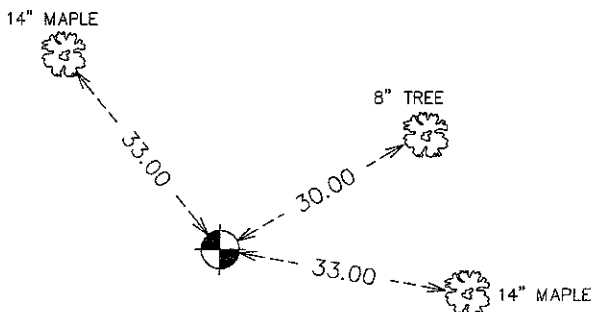

Statement of evidence relative to this corner location is on back of page.

I hereby certify that this document and the data contained herein was prepared by me or under my direct supervision.

Ernest Lund
Signature

11-27-10
Date

Registration No. 9808

- Land Surveyor, Professional Engineer
 County Surveyor, County Engineer

OFFICE OF THE COUNTY RECORDER

County of _____

I hereby certify that this document was filed in the County Recorder's office at _____ M. on the

_____ day of _____ A.D., 20____

County Recorder _____

BY _____ Deputy

DOCUMENT NO. _____

E1/4 CORNER, SEC. 23, T39, R24

STATEMENT OF EVIDENCE

IN JULY 1973 M.B. RUDE SET A KANABEC COUNTY MONUMENT IN A RESURVEY OF SECTIONS 23, 24, 26 AND 35 BY EXTENSION AT CENTERLINE OF HIGHWAY EXTENDED SOUTHERLY AND DISTANCE FORM HANDSAU SURVEY IN 1931. ALSO FIT OLD FENCE LINE 1/4 MILE WEST ON WEST SIDE OF RIVER. CENTERLINE AT CENTER OF SEC. 23 FITS HANDSAU'S NOTES OF 1931. COULD NOT FIND POST SET BY HANDSAU OR TREE TIES.

IN JUNE 2009 E.G. RUD AND SONS, INC. FOUND THIS MONUMENT AND ESTABLISHED KANABEC COUNTY COORDINATES ON THIS CORNER.