

CERTIFICATE OF LOCATION OF GOVERNMENT CORNER

EAST QUARTER On line Between 32, Township 40, Range 25, 4TH P.M.

STATE OF MINNESOTA, County of KANABEC

At the corner location shown on the sketch:

FOUND THIS MONUMENT
AND ESTABLISHED G.P.S. COORDINATES ON ITS LOCATION.

Kanabec County U.S. Survey Feet Coordinates
NAD 1983, HARN 1996 Adjustment
Obtained by RTK GPS Observation

Northing= 167722.00

Easting= 353575.43

Note: NAD 1983, HARN 1996 Adjustment
coordinates are NOT compatible with
NAD 1983 coordinates

Note: 1 Meter=3937/1200 U.S. Survey Feet

SKETCH OF REFERENCE TIES

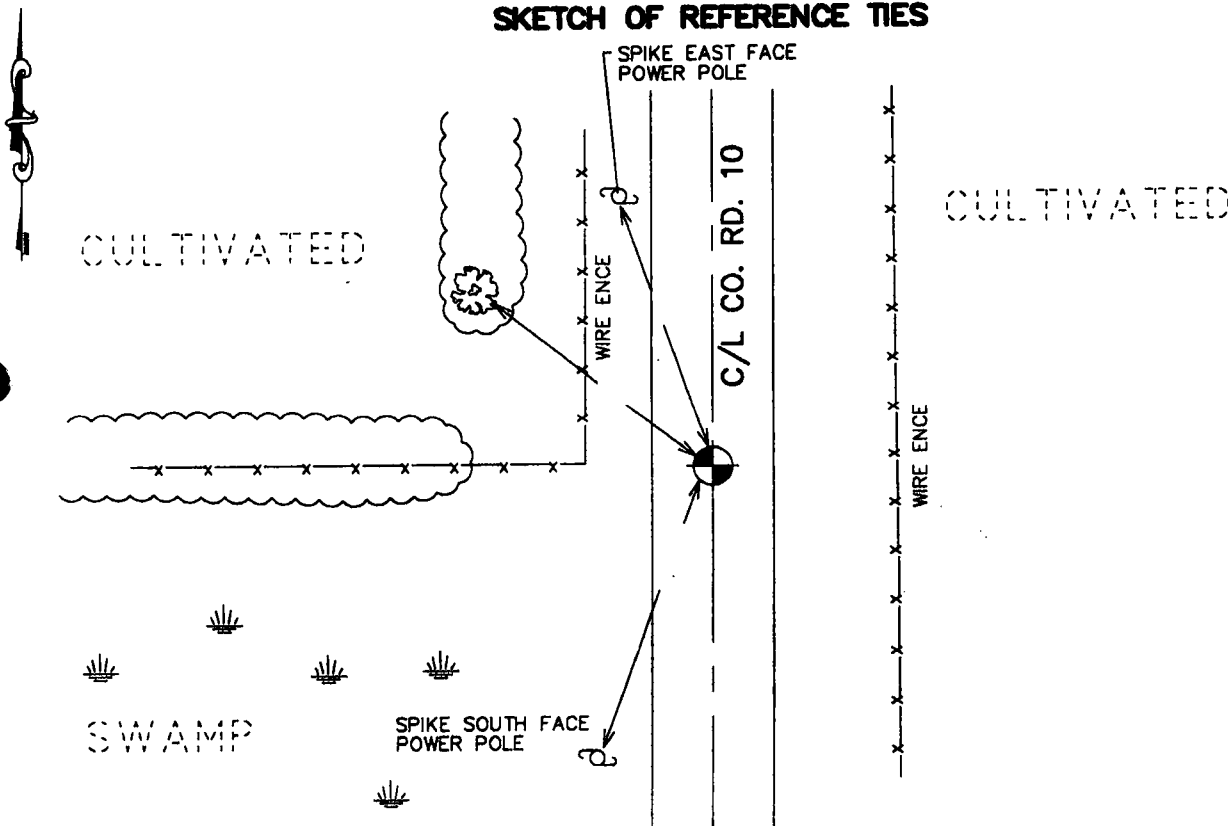

NOTE: C.I.M. IS DOWN 0.3' BELOW
ROAD SURFACE

Statement of evidence relative to this corner location is on back of page.

I hereby certify that this document and the data
contained herein was prepared by me or under
my direct supervision.

Ernest Reed 2-13-2007
Signature Date

Registration No. Minn No 9808

Land Surveyor, Professional Engineer

County Surveyor, County Engineer

OFFICE OF THE COUNTY RECORDER

County of Kanabec

I hereby certify that this document was filed in
the County Recorder's office at 2:30 P.M. on the

14 day of Feb A.D., 2007

County Recorder Rhonda A Olson

BY _____ Deputy

DOCUMENT NO. _____

EAST QUARTER CORNER SECTIONS 32, T40, R25

STATEMENT OF EVIDENCE

THE EAST QUARTER CORNER OF SECTION 32 WAS ORIGINALLY SET IN 1855 BY SILAS BARNARD, DEPUTY SURVEYOR. A POST WAS PLACED AND WITNESS TREES ESTABLISHED. NO REMAINS OF THE POST OR WITNESS TREES WERE FOUND.

MIKE TRUNK PLACED A CAST IRON MONUMENT AT THE ESTABLISHED OCCUPATION LINES. THIS POSITION FITS WELL WITH THE OTHER OCCUPATION LINES ALONG THE EAST LINE OF THE NORTHEAST QUARTER OF SECTION 32.

ON SEPTEMBER 18, 1992 AT THE REQUEST OF THE KANABEC COUNTY SURVEYOR MIKE EXCAVATED AT THE SUBJECT CORNER IN AN AREA OF 3' EAST 3' WEST 8' NORTH AND 8' SOUTH OF OUR CORNER POSITION AT A DEPTH OF 3' AND FOUND NO EVIDENCE OF A CORNER POSITION. THE CAST IRON MONUMENT WAS REPLACED JULY 21, 1993.

IN 2003 E.G. RUD AND SONS FOUND THIS MONUMENT AND ESTABLISHED KANABEC COUNTY COORDINATES ON THE LOCATION USING G.P.S. EQUIPMENT.