

CERTIFICATE OF LOCATION OF GOVERNMENT CORNER

NORTHEAST Corner of Section 21, Township 40, Range 25, 4TH P.M.
 STATE OF MINNESOTA, County of KANABEC

At the corner location shown on the sketch:
 SET A KANABEC COUNTY MONUMENT

Kanabec County U.S. Survey Feet Coordinates
 NAD 1983, HARN 1996 Adjustment
 Obtained by RTK GPS Observation

Northing= 180263.60

Easting= 359332.98

Note: NAD 1983, HARN 1996 Adjustment
 coordinates are NOT compatible with
 NAD 1983 coordinates

Note: 1 Meter=3937/1200 U.S. Survey Feet

SKETCH OF REFERENCE TIES

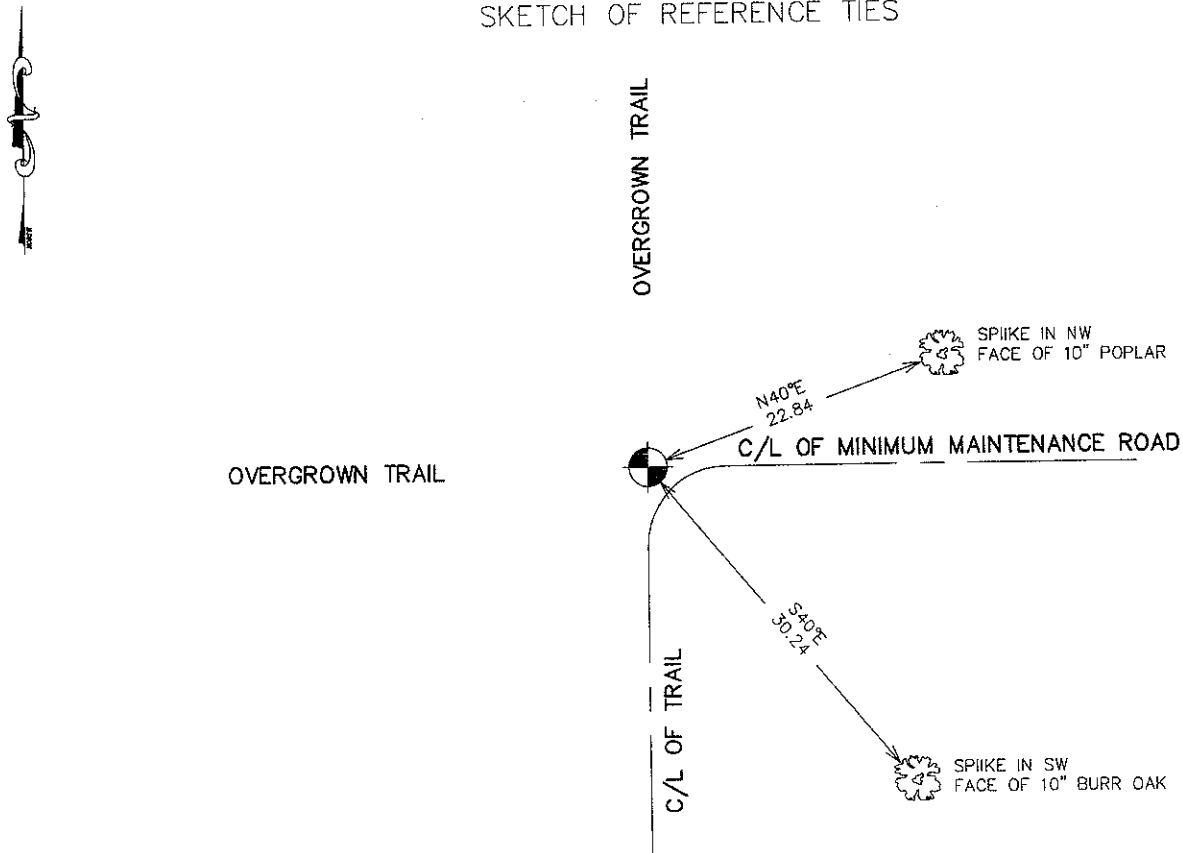

Statement of evidence relative to this corner location is on back of page.

I hereby certify that this document and the data contained herein was prepared by me or under my direct supervision.

Ernest Glad
 Signature

2-02-2010
 Date

Registration No. 9808

- Land Surveyor, Professional Engineer
 County Surveyor, County Engineer

OFFICE OF THE COUNTY RECORDER

County of _____

I hereby certify that this document was filed in the County Recorder's office at _____ M. on the

_____ day of _____ A.D., 20__

County Recorder _____

BY _____ Deputy

DOCUMENT NO. _____

NE CORNER, SEC. 21, T40, R25

STATEMENT OF EVIDENCE

ORIGINAL GOVERNMENT POST WAS SET ON NOVEMBER 3, 1855 BY DEPUTY SURVEYOR SILAS BARNARD AND 4 BEARING TREES WERE NOTED. NO VISIVLE EVIDENCE REMAINS TODAY OF FOR THE POST OR BEARING TREES.

THIS CORNER FALLS AT THE INTERSECTION OF TRAILS RUNNING SOUTH AND EAST.

IN NOVEMBER 1909, JOHN NELSON DID A ROAD SURVEY ALONG THE EAST LINE OF SEC. 21 AND 28. JOHN DIDN'T STATE WHAT HE SET BUT HIS MEASUREMENT ALONG THE EAST LINE OF SEC. 28 WAS 5192.2 FEET AND TODAY WE MEASURE 5195 FEET. ALONG THE EAST LINE OF SEC. 21 JOHN MEASURED 5070.8 AND TODAY WE MEASURE 5070.76 FEET.

WE ACCEPTED THE CENTERLINE-CENTERLINE INTERSECTION OF THE TRAILS TO BE THE BEST EVIDENCE FOR THE PERPETUATION OF THIS CORNER BEING THAT IT FIT JOHN NELSON'S MEASUREMENTS SO CLOSE.

IN DECEMBER 2003 AN EXCAVATION WAS DONE AT THIS LOCATION WITH A BACKHOE, BUT NO EVIDENCE WAS FOUND. A KANABEC COUNTY MONUMENT WAS SET, TIES TAKEN AND KANABEC COUNTY COORDINATES ESTABLISHED ON THIS POSITION.