

# CERTIFICATE OF LOCATION OF GOVERNMENT CORNER

S. 1/4 Corner of Section 11, Township 40, Range 25, 4 P.M.

STATE OF MINNESOTA, County of KANABEC

At the corner location shown on the sketch

On 4-13-81 found a WOOD POST  
Date

left monument as found,  lowered monument,  removed monument (explain)  
 On 5-07-81 placed a 4" x 18" C.I.M. AND FENCE POST  
Date

### SKETCH OF REFERENCE TIES

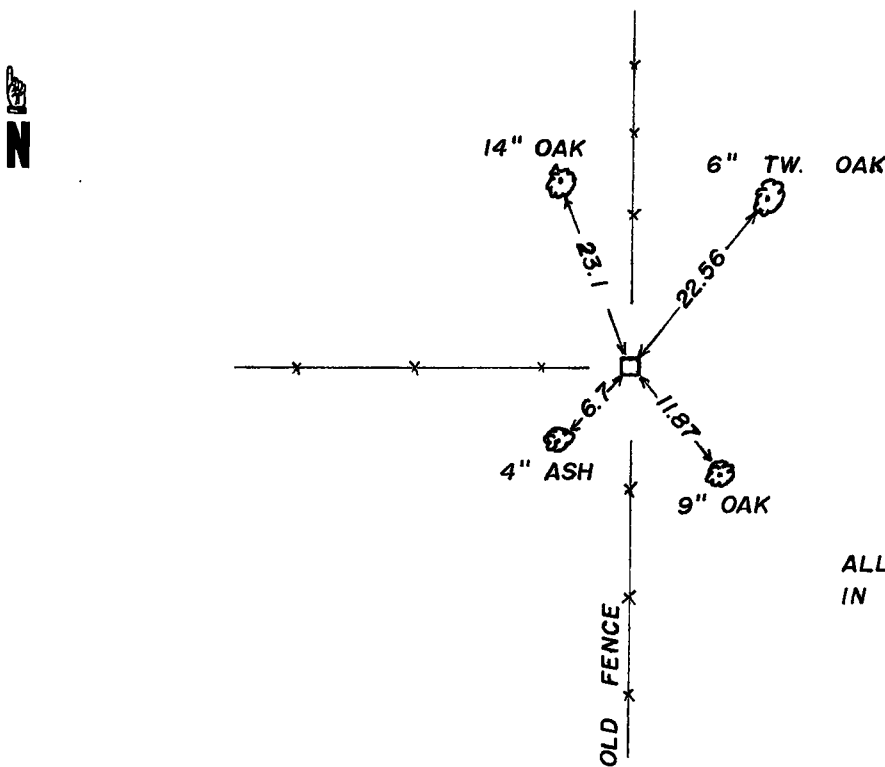

ALL TIES ARE TO SPK.  
IN BLAZE IN NEAR FACE

Statement of evidence relative to this corner location is on back of page.

I hereby certify that this document and the data contained herein was prepared by me or under my direct supervision.

M. D. [Signature] 5-27-81  
Signature Date

Registration No. 8195

Land Surveyor,  Professional Engineer

County Surveyor,  County Engineer

### OFFICE OF THE REGISTER OF DEEDS

County of Kanabec

I hereby certify that this document was filed in the Register of Deeds office at 11 P. M. on the

27 day of August A.D., 1981

Register of Deeds Velma J. Besser

By \_\_\_\_\_, Deputy

DOCUMENT NO. \_\_\_\_\_

STATEMENT OF EVIDENCE

All of the original bearing trees are now gone.

There is no resurvey data on file for this corner.

On April 13, 1981, We made a survey around Section 11 to locate the existing monuments and lines of occupation.

We found the base of a very rotted post and evidence of fence lines at this location and accepted this as the best available evidence of the original corner location, as it is within four feet of a split of the south line and in harmony with accepted lines of occupation.