

CERTIFICATE OF LOCATION OF GOVERNMENT CORNER

NORTHEAST Corner of Section 35, Township 40, Range 25, 4TH P.M.

STATE OF MINNESOTA, County of KANABEC

At the corner location shown on the sketch:

FOUND THIS MONUMENT
AND ESTABLISHED KANABEC COUNTY COORDINATES ON ITS LOCATION.

Kanabec County U.S. Survey Feet Coordinates
NAD 1983, HARN 1996 Adjustment
Obtained by RTK GPS Observation

Northing= 169257.59

Easting= 370084.55

Note: NAD 1983, HARN 1996 Adjustment
coordinates are NOT compatible with
NAD 1983 coordinates

Note: 1 Meter=3937/1200 U.S. Survey Feet

SKETCH OF REFERENCE TIES

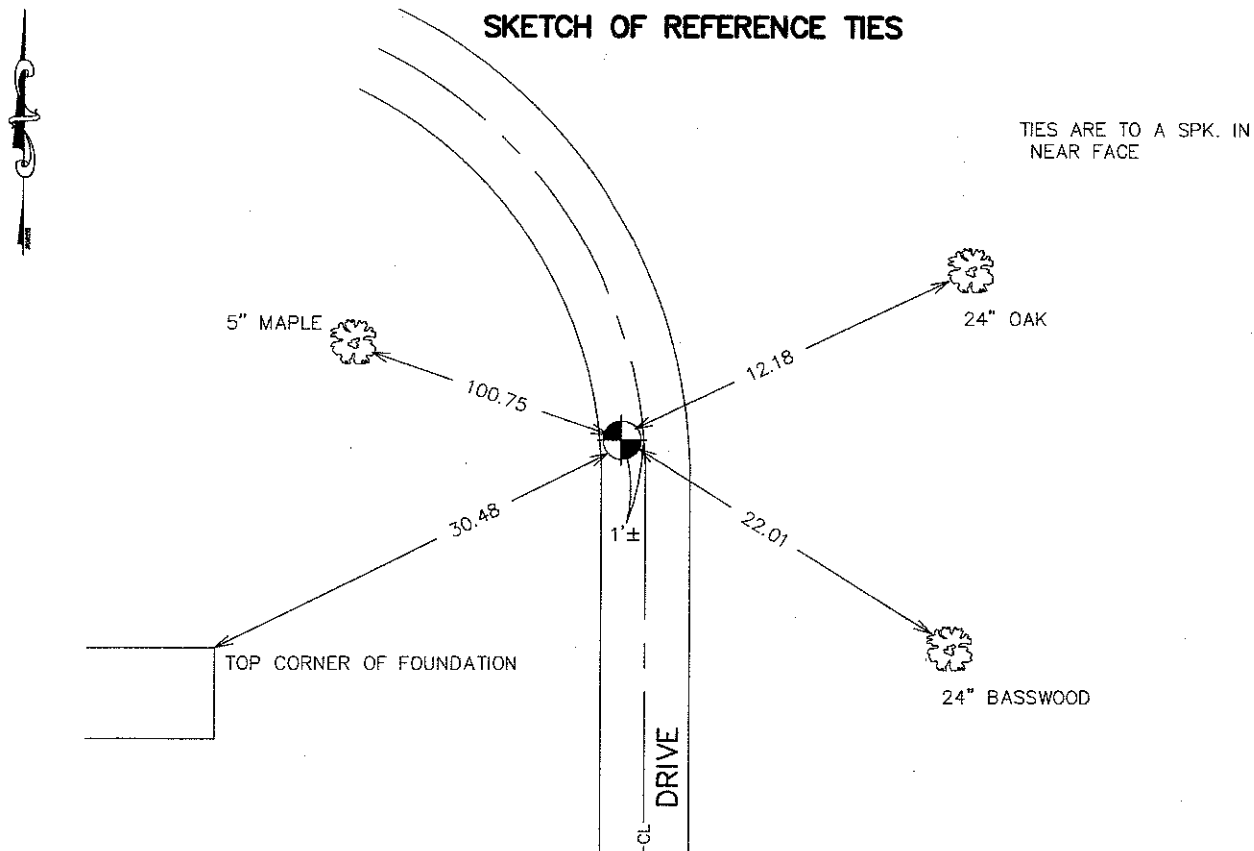

Statement of evidence relative to this corner location is on back of page.

I hereby certify that this document and the data contained herein was prepared by me or under my direct supervision.

Ernest J. Rud
Signature

11-25-2007
Date

OFFICE OF THE COUNTY RECORDER

County of _____

I hereby certify that this document was filed in the County Recorder's office at _____ M. on the

_____ day of _____ A.D., 20__

County Recorder _____

BY _____ Deputy

DOCUMENT NO. _____

Registration No. 9808

Land Surveyor, [] Professional Engineer

[] County Surveyor, [] County Engineer

NORTHEAST CORNER SECTION 35, T40, R25

STATEMENT OF EVIDENCE

THE ORIGINAL CORNER WAS SET BY DEPUTY SURVEYOR SILAS BARNARD ON OCTOBER 27, 1855 AND TWO TAMARACK TREES ESTABLISHED AS BEARING TREES. NO VISIBLE EVIDENCE OF CORNER OR BEARING TREES REMAIN.

IN BOOK A1 OF SURVEYS, PAGE 62 AND 63 JOHN NELSON RECORDED A SURVEY OF SECTION 25 DATED SEPTEMBER 12TH 1910. ON THAT SURVEY JOHN SET A SANDSTONE MARKED WITH AN X FOR THE NORTHEAST CORNER OF SECTION 35.

ON SECTION CORNER CERTIFICATE NO. 253 GERALD SULLIVAN STATES HE FOUND A 1" X 16" IRON PIPE OVER A 10" X 10" SANDSTONE INSCRIBED WITH A CROSS IN SEPTEMBER 1970. HE SET A CAST IRON MONUMENT OVER THE SANDSTONE.

IN JULY 1996 M.B. RUDE FOUND THIS CAST IRON MONUMENT AND TOOK 4 TIES TO THE CORNER.

IN JULY 2007 E.G. RUD AND SONS FOUND THIS CAST IRON MONUMENT AND ESTABLISHED KANABEC COUNTY COORDINATES ON THIS CORNER.