

# CITY OF EAST JORDAN WATER SYSTEM

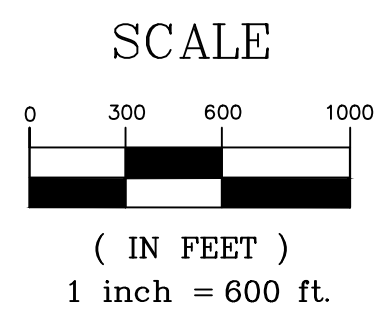

- CITY LIMITS
- 2-4" WATER MAIN
- 6" WATER MAIN
- 8" WATER MAIN
- 10" WATER MAIN
- 12" WATER MAIN
- 14" WATER MAIN
- FIRE HYDRANT
- + WATER VALVE

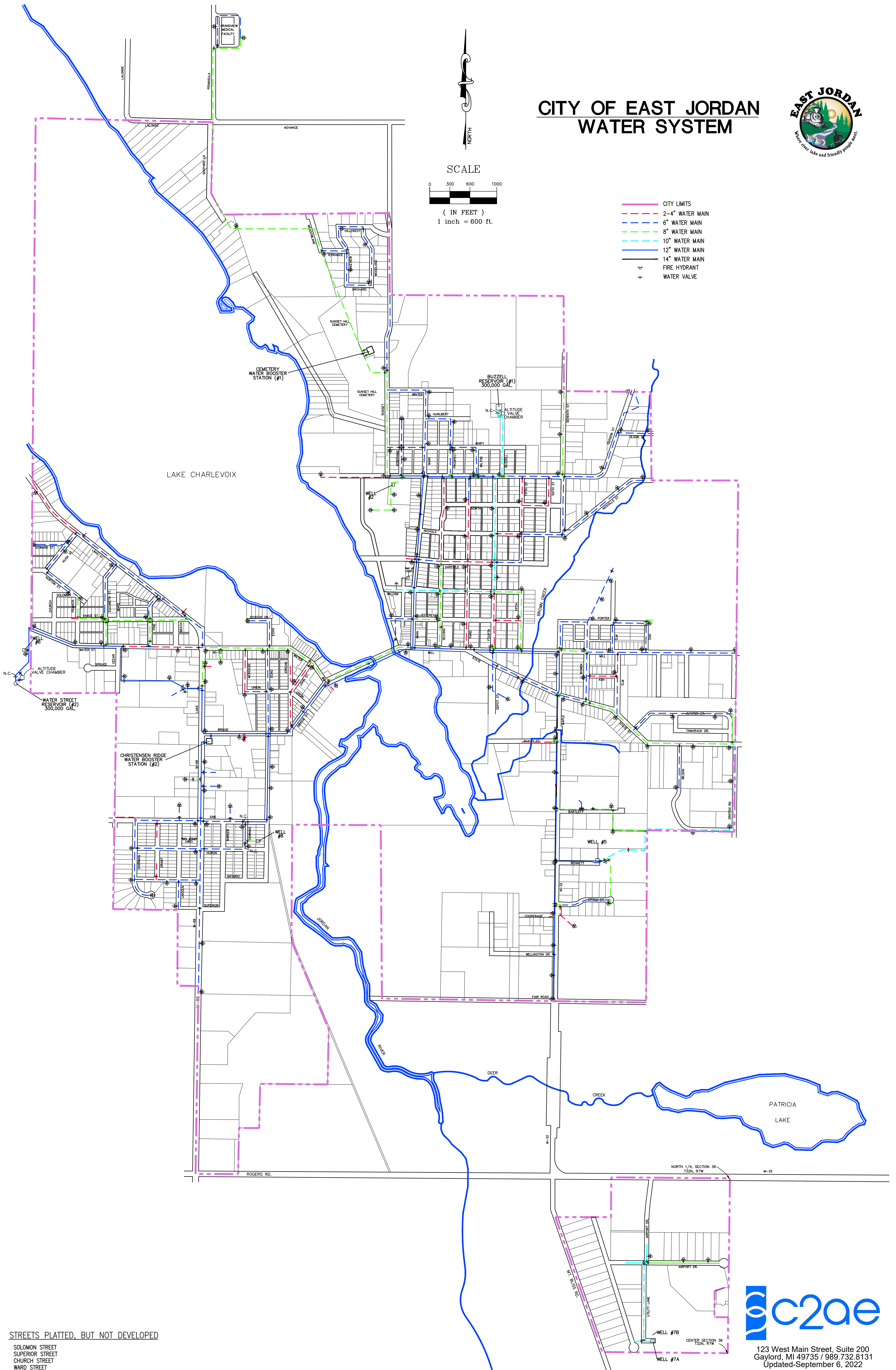

STREETS PLATTED, BUT NOT DEVELOPED  
SOLOMON STREET  
SUPERIOR STREET  
CHURCH STREET  
WARD STREET



123 West Main Street, Suite 200  
Gaylord, MI 49735 / 989.732.8131  
Updated-September 6, 2022