

SIGN PERMIT APPLICATION

Project Name: GOLDEN CENTURY SPA
Project Street Address: 480 NEW ROCHELL RD
Section: 552469 **Block:** 65 **Lot(s):** 2-9 **Zone:** _____
 (Section, Block and Lot and Zoning District information MUST be completed by the applicant)

Owner: VINCENT PERRIELLO
Address: 480 NEW ROCHELLE ROAD LLC
Phone #: 914-664-4727 **Email:** _____

Lessee: Weiyi Teng
Address: 480 New Rochell Rd Eastchester NY
Phone #: 914-426-5655 **Email:** _____

Sign Company: Westchester Sign **Contact Name** Stuart
Address: 361 Sawmill River Rd. Yonkers NY 10701
Phone #: 914-423-3610 **Email:** westsign1@aol.com

* Is lighting being proposed? Yes _____ No X If "YES", is lighting New _____ or Existing _____

* If lighting is "Existing", is the existing lighting/electrical being altered? Yes _____ No _____

* **Please Note** * If proposed lighting is "New" or being "Altered", a separate **Electrical Permit** is required.

APPLICATION CHECKLIST

Submission Items	Check Box
Completed Sign Application and Application Checklist	
Design/construction details of each proposed sign/awning at a legible and measurable scale showing: <input type="checkbox"/> Proposed lettering, colors and graphics <input type="checkbox"/> All proposed dimensions (sign height, length and thickness; letter heights and widths; etc.) <input type="checkbox"/> Construction details (including, but not necessarily limited to, how the sign will be attached to a building facade or anchored to the ground)	X
Building elevations and/or photo simulations showing the location of all proposed signs/awnings and proposed lighting (and, where applicable, all existing signs proposed to remain), including: <input type="checkbox"/> The dimension of the storefront on which the sign will be located. (Measured from the outside edge of the exterior building walls or from the center line of shared walls. Note that proposed wall signs may not exceed 75% of the length of the storefront) <input type="checkbox"/> The dimension of the sign above the sidewalk or ground plane. <input type="checkbox"/> The type and location of proposed lighting fixtures.	X
For free standing signs, a site plan showing: <input type="checkbox"/> The proposed location of the free-standing sign. (Note that free-standing signs must be located within the property lines and may not be located within or overhanging a public right-of-way). <input type="checkbox"/> Proposed landscaping, if applicable. <input type="checkbox"/> The type and location of proposed lighting, if applicable.	
Physical samples of proposed colors and materials. (If possible, provide fabric and color sample swatches with each application; Bring samples to the Sign Review meeting).	X
Catalogue cut sheets of proposed lighting fixtures	
Color photographs of the existing building/premises, showing existing conditions, and adjacent properties a minimum of 100 feet to the left and right and on the opposite side of the road. (Black and white or unclear photographs will not be accepted.)	X
If the proposed signs/awnings do not conform to all requirements of the Sign Law, the applicant <u>MUST</u> provide drawings which show fully conforming signs for comparison by the ARB, including: (1) dimensioned drawings of the conforming signs; and (2) building elevations or photo simulations showing the conforming signs.	

March 7, 2019

Ownership
AFFIDAVIT OF MAILING

Check One:

Planning Board

Zoning Board of Appeals

Architectural Review Board

Name and Location of Project: 480 NEW ROCHELLE ROAD EASTCHESTER NY 10709

Golden Century Spa

Section 552489, Block B5, Lot(s) 229

State of New York }

County of Westchester }

ss:

I, VINCENT PERRIELLO, being duly sworn, depose and say as follows:

1. I am the agent, owner or legal representative of the referenced property.
2. I have prepared a list of property owners located within 200 feet of the boundaries of the referenced property, by street address and section, block and lot.
3. I have sent, by certificate of mailing, a copy of the legal notice to each and every property owner within 200 feet of the boundaries of the referenced property.
4. I have published the legal notice in a newspaper of general circulation in the Town of Eastchester on _____, 20____, no less than 10 days prior to a Planning Board or Zoning Board of Appeals meeting and no less than 5 days prior to an Architectural Review Board meeting.
5. I have attached the affidavit of publication from the publisher of the newspaper.
6. I understand that I must bring this signed and notarized Affidavit of Publication, along with the certificate of mailing receipts, to the noticed meeting and that I must submit these items to the Board prior to being heard.

VINCENT PERRIELLO
(print name)

(signature)

Sworn to me this 3 day of February, 2021

Valon Nikci
(Westchester County Notary Public)

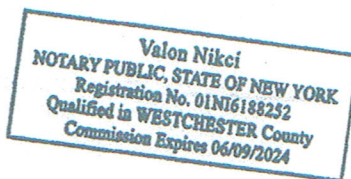

Town of Eastchester

October 31, 2017

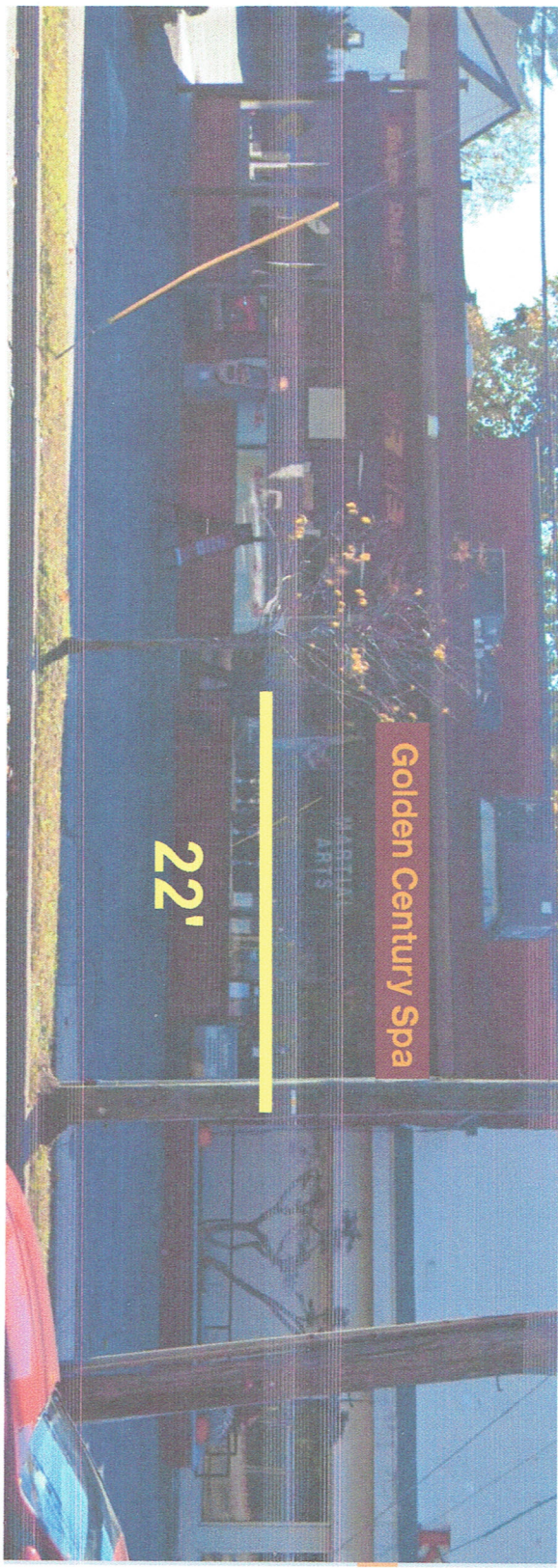

Aluminum Commercial Sign Burgundy Background With Vinyl Letters

189 in
174.8 in



Upper case letters = 16.75"
Lower case letters 8.75"

Sign Body color _____ Sign face color _____ Sign Trim color _____ For internal use Only



NOTE: All electric final hook ups are done by others, a separate electric permit & fee may be required by your municipality to obtain a sign permit. ALL signs are mounted at least 10' above grade unless otherwise noted above. All signs and related items remain property of Westchester Sign and can be removed at any time until paid for in full.

Westchester
SIGNS
361 Sawmill River Rd., Yonkers, N.Y.
914-423-3610

Project
480 New Rochelle rd
Eastchester Ny

Notes and details
pages

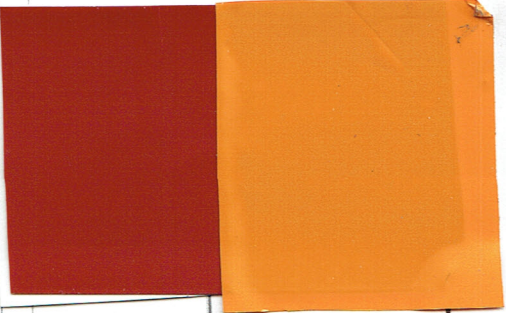



ACROSS THE STREET



NEXT DOOR

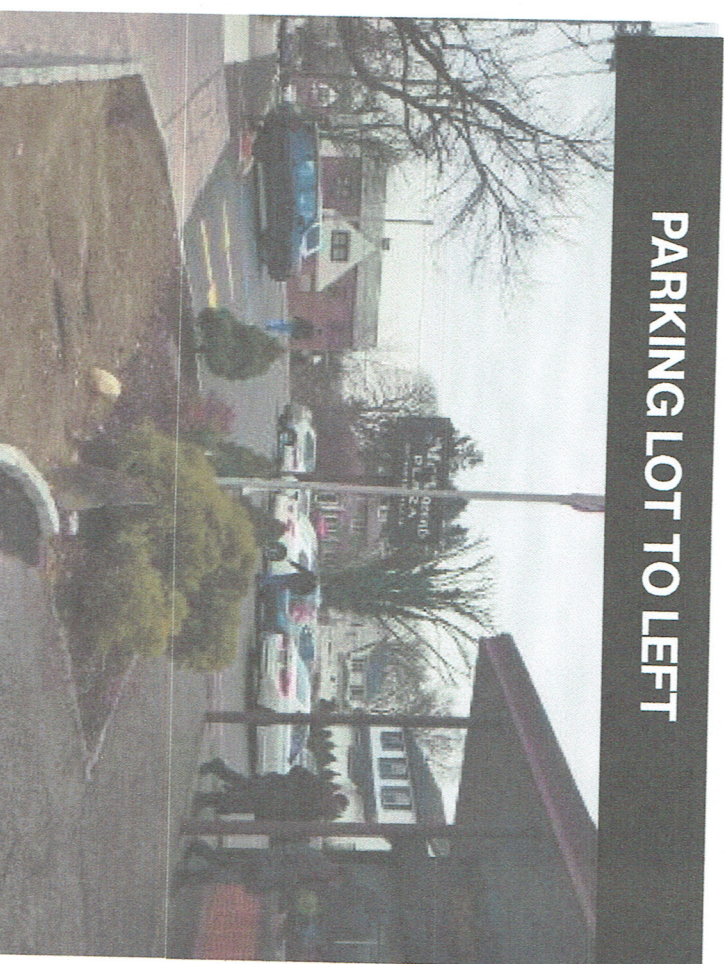

PARKING LOT TO LEFT