



# City of Crescent Springs

739 Buttermilk Pike  
Crescent Springs, Kentucky 41017  
Telephone: 859-341-3017  
Fax: 859-341-3518  
[www.crescent-springs.ky.us](http://www.crescent-springs.ky.us)

City Administrators Report  
Council Meeting  
Monday, June 26, 2023

## Report Talking Points:

### 755 Western Reserve Road Development Discussion:

- Last week I received a phone call from Brian Fullenkamp with the Legacy Management Firm in Fort Wright.
- It is regarding the continued interest in developing the property located at 755 Western Reserve Road.
- Brian approached the city back in April of this year and would like to sit back down to discuss preliminary plans/legal research with the city.

### Ireland Avenue Development Discussion:

- Brian Fullenkamp and Legacy Management Firm want to also discuss/review another potential development that they are researching in the city. It is the site located along Ireland Avenue and Harris Street (*Behind Panera*).
- Research shows that the comprehensive plan does identify this area for mixed uses of residential, commercial, and office. The property is currently zoned R-2.
- Staff has scheduled a meeting for both discussions on Thursday, June 29<sup>th</sup> at 11:00am here at the City Building.

### Storm Sewer Water Project (*Crescent Avenue, Park Street, and Croley*):

- Storm sewer bid package is available at Berling Engineering's office.

Take care,

Mike Daly



# LINK-GIS Web Map

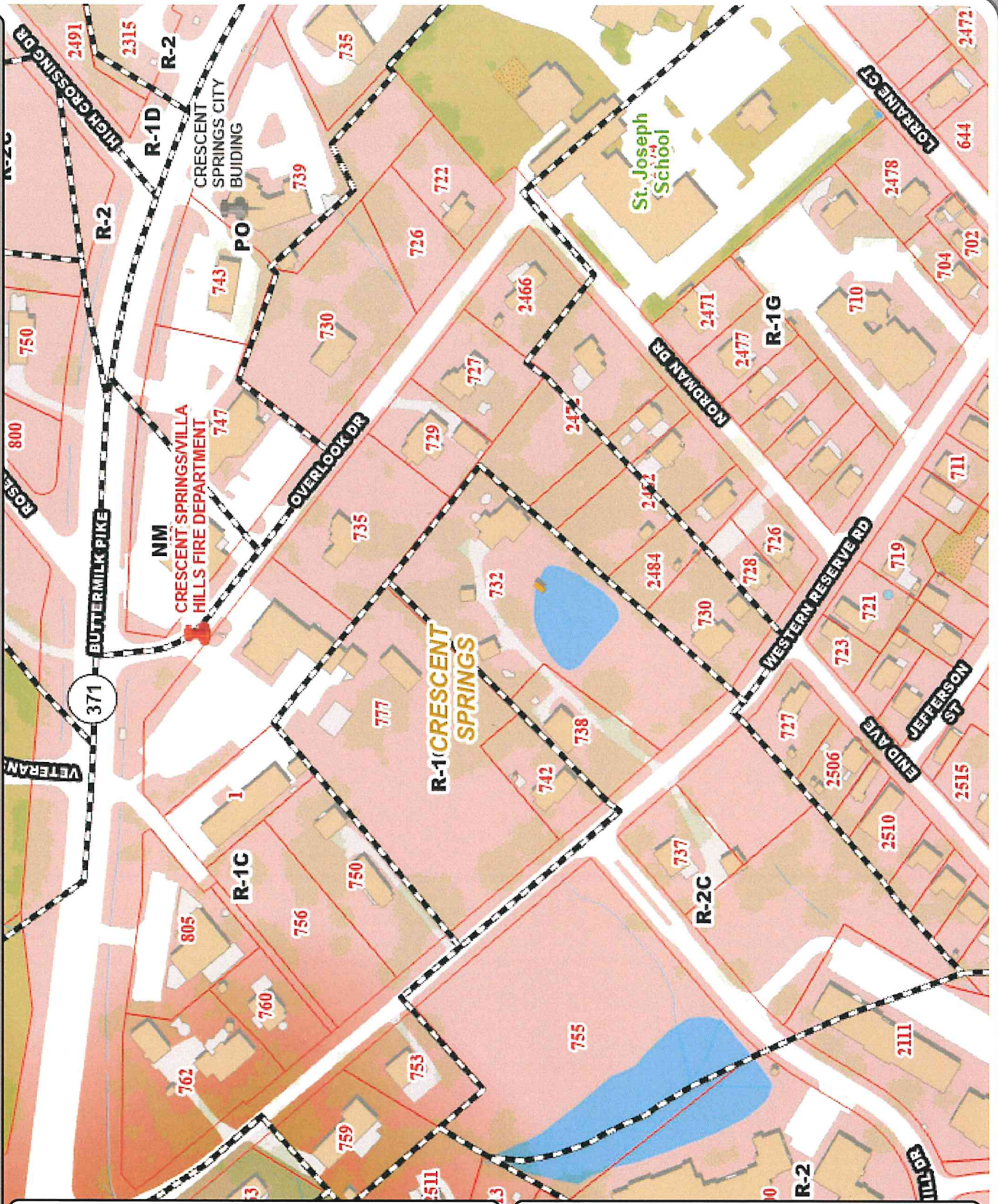

<b>Building</b>	<b>Recreation</b>	<b>Roads</b>	<b>Topography</b>	<b>Boundaries</b>	<b>Utilities</b>
Building	Ball Fields	Paved Road	Index Contour	Parcel	Sewer
Pool	Playground/General Rec	Unpaved Road	Intermediate Contour	Water Pipe	Structure
Tank	Tee/Green	Bridges	Creek / Stream	Water Hydrant	Water Pipe
Concrete Pad		Paved Parking	River / Lake		
		Unpaved Parking			
		Railroad			

1:2,400

0 50 100 200 Feet

↑

1840 Simon Kenton Way  
Covington, KY 41011  
859.331.8980  
Office hours M-F 8-5  
[www.linkgis.org](http://www.linkgis.org)

Parcel data provided by CCPVA, KCPVA, PCPVA and LINK-GIS.

**Date: 3/31/2023**

These GIS data are deemed reliable and every effort has been made to ensure their accuracy. They are, however, provided "as is" without warranty of correctness, timeliness, reliability, or completeness. Map elements do not represent a legal survey of land. Use of these data for any purpose should be with an acknowledgement of their limitations, including the fact that they are dynamic in nature and in a constant state of maintenance. Field investigation may be necessary.





# Location



**Building**

- Building
- Pool
- Tank
- Concrete Pad

**Recreation**

- Ball Fields
- Playground/General Rec
- Tee/Green

**Roads**

- Paved Road
- Unpaved Road
- Bridges
- Paved Parking
- Unpaved Parking
- Railroad

**Boundaries**

- Parcel
- Zoning

**Utilities**

- Sewer
- Sewer Structure
- Water Pipe
- Water Hydrant

**Topography**

- Index Contour
- Intermediate Contour
- Creek / Stream
- River / Lake

1 inch equals 60 feet



1840 Simon Kenton Way, Suite 3400  
Covington, KY 41011-2999  
859.331.8980  
Office hours M-F 8-5  
[www.linkgis.org](http://www.linkgis.org)

Parcel data provided by CCPVA,  
PCPVA and LINK-GIS.

Date: 11/24/2021



These GIS data are deemed reliable and every effort has been made to ensure their accuracy. They are, however, provided "as is" without warranty of correctness, timeliness, reliability, or completeness. Map elements do not represent a legal survey of land. Use of these data for any purpose should be with an acknowledgement of their limitations, including the fact that they are dynamic in nature and in a constant state of maintenance. Field investigation may be necessary.