

VILLAGE OF BURR RIDGE

CONTROL MONUMENT DIAGRAM

DATE: 11-16-05

STATION NAME: BM #108

STATION LOCATION:

SET MONUMENT LOCATED AT THE NORTHWEST CORNER OF THE SOUTH FRONTAGE ROAD AND 75TH STREET

NORTHING: 1852879.90
EASTING: 1098069.17
ELEVATION: 709.33

STATION DESCRIPTION:

BERNTSEN MONUMENT CONSISTING OF 9/16" DIA. STAINLESS STEEL ROD INSIDE GREASE FILLED 1" DIA. PVC, DRIVEN TO A REFUSAL DEPTH OF 8 FEET ENCLOSED IN SAND AND 6" PVC PIPE WITH ALUMINUM ACCESS COVER. (REFUSAL IS DEFINED BY NGS AS A DRIVING RATE OF 60 SECONDS PER FOOT WITH A 52 LB JACKHAMMER.)

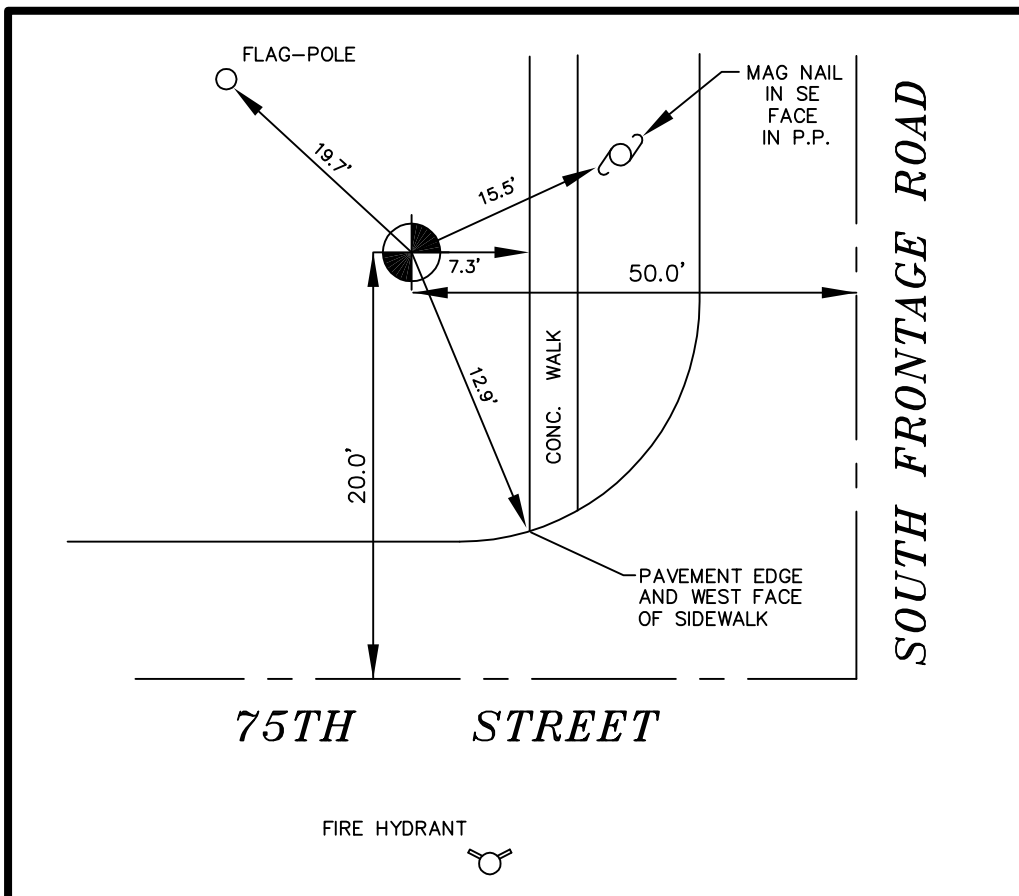
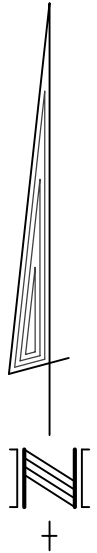

Area Survey Company

11340 West 159th Street
Orland Park, Illinois 60467

\\6000\6103\BM 108
1-04-06 * CSS

Phone: (708) 349-7364

Fax: (708) 349-7372

E-mail: areasurvey@sbcglobal.net